

AIRBUS  
CUSTOMER SERVICES DIRECTORATE  
1 Rond Point Maurice Bellonte  
31707 BLAGNAC CEDEX  
FRANCE  
Tel : (33) 5 61 93 33 33  
Telex : AIRBU 530526F  
Fax : (33) 5 61 93 42 51

This summary is for information only and is not approved for modification of the aircraft.

## **MANDATORY MANDATORY MANDATORY**

ATA SYSTEM: 34

**TITLE: NAVIGATION - GENERAL - REPLACE AOA PROBE CONIC PLATE BY  
AOA PROBE FLAT PLATE**

**\*\*CONF ALL**

### **MODIFICATIONS**

| MODIFICATION CLASSIFICATION |              |  |  |  |  |
|-----------------------------|--------------|--|--|--|--|
| MAJOR                       | 203295S32646 |  |  |  |  |
| MINOR                       | None         |  |  |  |  |

**NOTE:** As per EASA IR 21, a minor change is one that has no appreciable effect on the mass, balance, structural strength, reliability, operational characteristics affecting the airworthiness of the product. All other changes are major changes.

### **REASON/DESCRIPTION/OPERATIONAL CONSEQUENCES**

Following a recent in-service event, as a precautionary measure, Airbus requires to suspend the installation of the AOA (Angle Of Attack) conic plates as per Operator Information Transmission (OIT) No. 999.0086/12, currently performed through an Airbus monitored campaign with Service Bulletin No. A340-34-5081.

This modification requires the removal of the conic plates PN F3411060200000 and PN F3411060900000, and the installation of flat plates PN F3411007920200 (LH) / PN F3411007920300 (RH).

Also, it requires to change the 3 AOA Sensor Protection Covers (FINs 7955ME, 7956ME and 7957ME) stored in Flight Kit No 2 (FIN 7500NW or FIN 7503NW).

Refer to OIT No. 999.0086/12 and FOT No. 999.0089/12 for further explanations.

For aircraft already fitted with the AOA conic plates through retrofit or from production, Airbus released associated operational recommendations in an FOT No. 999.0089/12, the Operations Engineering Bulletin (OEB) 45 and Flight Manual (FM) Temporary Revision 294.

This Service Bulletin modifies the Ground System Equipment (the AOA Protection Covers) needed for parking, mooring or storing the aircraft.

## SERVICE BULLETIN SUMMARY

Accomplishment of this Service Bulletin cancels OEB 45 and FM TR294. It is expected that an Airworthiness Directive (AD) published by the European Aviation Safety Agency (EASA) will be issued to confirm this cancellation.

This Service Bulletin modifies the Ground System Equipment (the AOA Protection Covers) needed for parking, mooring or storing the aircraft.

The operational consequence of this Service Bulletin is the modification of the Flight Manual (FM) and Flight Crew Operating Manual (FCOM) by removing temporary operational measures introduced by OEB 45, FOT No. 999.0089/12 and FM TR294.

### GENERAL EVALUATION

| EVALUATION TABLE     |               |                        |     |
|----------------------|---------------|------------------------|-----|
| COMPLIANCE           | MANDATORY (1) | CANCELS INSPECTION SB  | NO  |
| POTENTIAL AD         | YES           | A/C OPERATION AFFECTED | YES |
| RELIABILITY AFFECTED | NO            | PAX COMFORT AFFECTED   | NO  |
| COST SAVING          | NO            | LROPS AFFECTED         | NO  |
| STRUCTURAL LIFE EXTN | NO            | VENDOR SB INVOLVED     | NO  |

NOTE (1): Service Bulletin must be accomplished.

### MATERIAL PRICE INFORMATION

**\*\*CONF 001**

| MATERIAL PRICE INFORMATION TABLE |             |                     |                     |
|----------------------------------|-------------|---------------------|---------------------|
| MATERIAL SET                     | QTY PER A/C | PRICE PER A/C (USD) | MAIN PARTS          |
| Component COMPA01                | 1           | See SB              | Flat Plates, Covers |
| Component COMPA02                | 1           | See SB              | Screws              |

**\*\*CONF 002**

| MATERIAL PRICE INFORMATION TABLE |             |                     |                     |
|----------------------------------|-------------|---------------------|---------------------|
| MATERIAL SET                     | QTY PER A/C | PRICE PER A/C (USD) | MAIN PARTS          |
| Component COMPA01                | 1           | See SB              | Flat Plates, Covers |
| Component COMPA02                | 1           | See SB              | Screws              |

### EFFECTIVITY

**\*\*CONF ALL**

This Service Bulletin is applicable to this (these) operator(s) :

06U 25R 36V 62X 70U 72W AHY CES CHH DLH ETD HFY IBE  
QAF QTR SAA SIA TAM THA UAE VIR

### CONCURRENT REQUIREMENTS

None

5 DATE: Jan 30/13

SERVICE BULLETIN No.: A340-34-5093

REVISION No.: 00 - Jan 30/13

Page: 2

**REFERENCES / REPERCUSSIONS**

|                           |                     |
|---------------------------|---------------------|
| TFU                       | None                |
| OEB                       | 45                  |
| AOT                       | None                |
| SIL                       | None                |
| LINE MAINTENANCE AFFECTED | No                  |
| LIFE LIMIT                | None                |
| OTHER                     | OIT No. 999.0086/12 |
| OTHER                     | FOT No. 999.0089/12 |

**NATURE OF THE WORK**

|           |     |
|-----------|-----|
| AIRCRAFT  | YES |
| EQUIPMENT | NO  |
| HARD      | NO  |
| SOFT      | NO  |
| OBRM      | NO  |

**MANPOWER****\*\*CONF 001**

|   |      |
|---|------|
| Task 345093-831-801-001: Modification of the AOA sensor plates. |      |
| TOTAL MANHOURS  | 6.25 |
| ELAPSED TIME (HOURS)  | 4.25 |

**\*\*CONF 002**

|   |      |
|---|------|
| Task 345093-831-801-001: Modification of the AOA sensor plates. |      |
| TOTAL MANHOURS  | 6.25 |
| ELAPSED TIME (HOURS)  | 4.25 |

**APPENDICES****\*\*CONF ALL**

APPENDIX 01: Elapsed Time Assumption

# A340-500/600

## SERVICE BULLETIN SUMMARY

**\*\*CONF ALL**

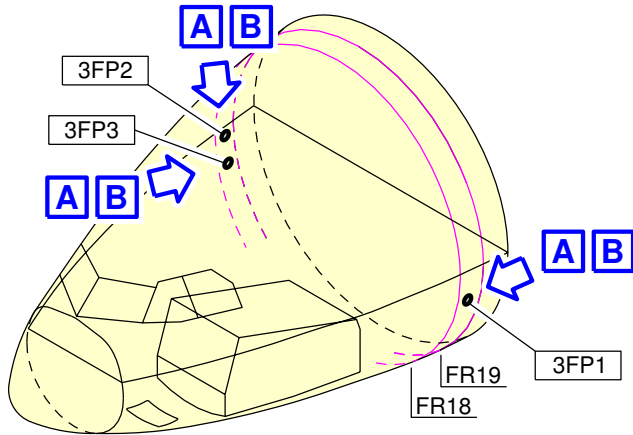

**BEFORE**



**THALES**

**OR**



**GOODRICH**

**A**

**NOTE:**

TYPICAL ILLUSTRATION ASSOCIATED WITH THALES OR GOODRICH AOA SENSORS.

F\_SB\_345093\_5\_SAAA\_01\_01

Figure A-FSAAA - Sheet 01

**\*\*CONF ALL**

**AFTER**



**C**

**NOTE:**

ONLY ONE CONFIGURATION SHOWN, AOA SENSOR  
DEPENDS ON AIRCRAFT CONFIGURATION.

TYPICAL ILLUSTRATION ASSOCIATED WITH THALES OR GOODRICH AOA SENSORS.

**CAUTION:**

NEW AOA FLAT PLATES SHALL NOT BE PAINTED AND SHALL REMAIN AS DELIVERED.

F\_SB\_345093\_5\_SAAA\_02\_01

Figure A-FSAAA - Sheet 02

# A340-500/600

## SERVICE BULLETIN SUMMARY

\*\*CONF 001

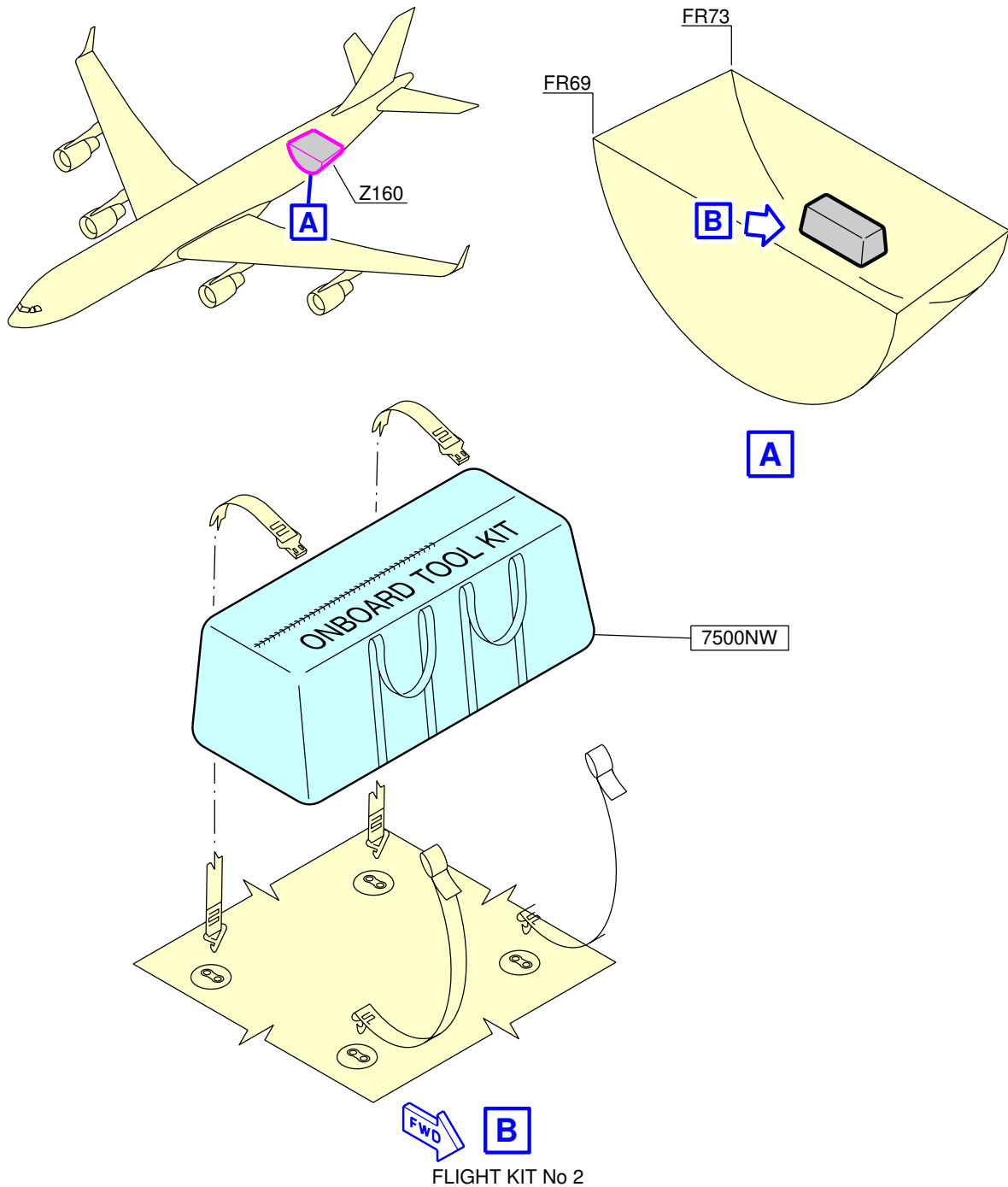

**NOTE:**

AOA PROTECTION COVERS FINs (7955ME, 7956ME AND 7957ME)  
ARE STORED IN FLIGHT KIT No 2 FIN (7500NW)

F\_SB\_345093\_5\_SBAA\_01\_01

Figure A-FSBAA - Sheet 01

# A340-500/600

## SERVICE BULLETIN SUMMARY

\*\*CONF 002

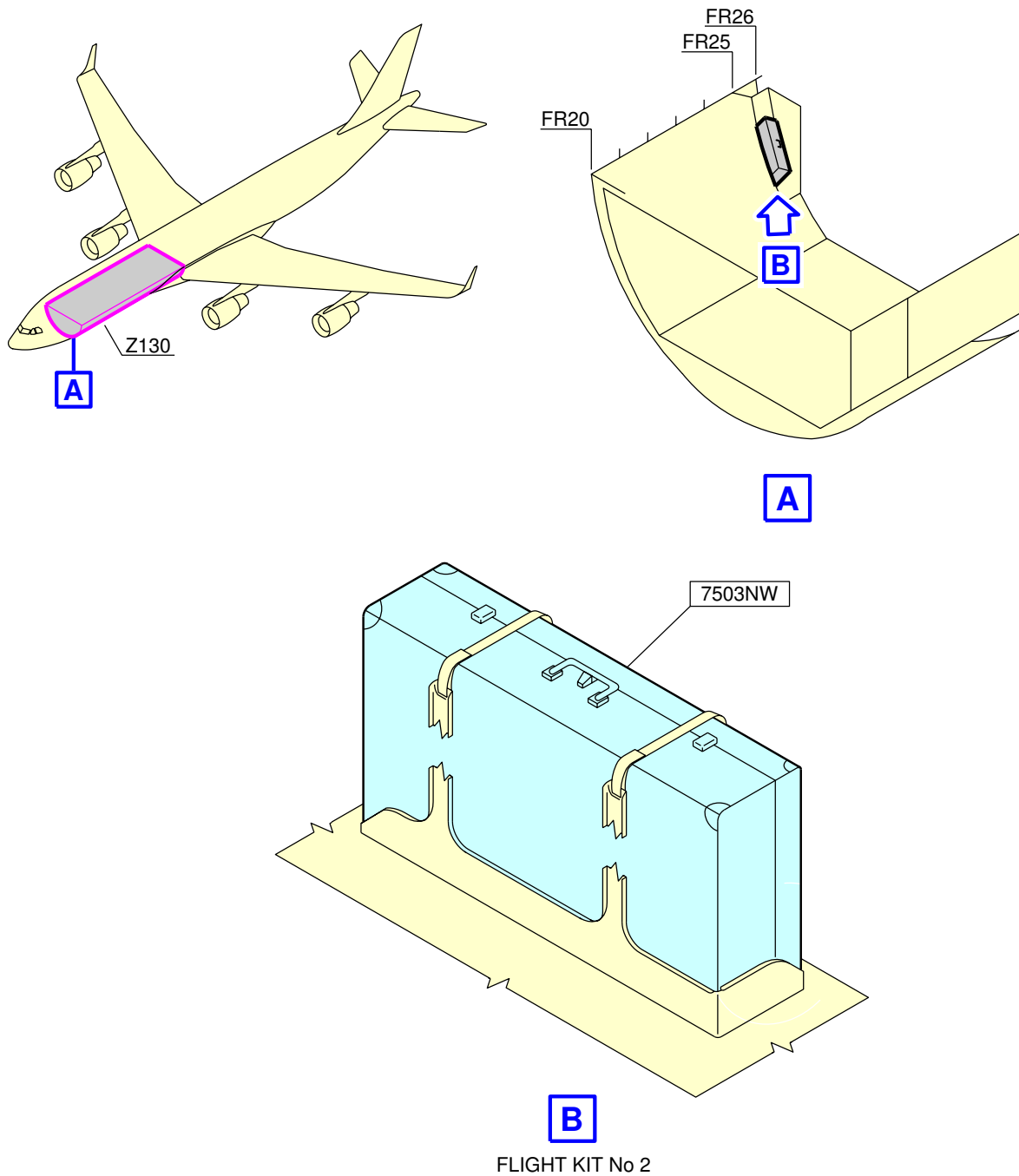

FLIGHT KIT No 2

**NOTE:**

AOA PROTECTION COVERS FINs (7955ME, 7956ME AND 7957ME)  
ARE STORED IN FLIGHT KIT No 2 FIN (7503NW)

F\_SB\_345093\_5\_SBAB\_01\_01

Figure A-FSBAB - Sheet 01

# **A340-500/600**

## SERVICE BULLETIN SUMMARY

This Page Intentionally Left Blank



AIRBUS  
CUSTOMER SERVICES DIRECTORATE  
1 Rond Point Maurice Bellonte  
31707 BLAGNAC CEDEX  
FRANCE  
Tel : (33) 5 61 93 33 33  
Telex : AIRBU 530526F  
Fax : (33) 5 61 93 42 51

## **MANDATORY MANDATORY MANDATORY**

ATA SYSTEM: 34

**TITLE: NAVIGATION - GENERAL - REPLACE AOA PROBE CONIC PLATE BY  
AOA PROBE FLAT PLATE**

MODIFICATION No.: 203295S32646

This document contains AIRBUS PROPRIETARY INFORMATION and shall at all times remain the property of AIRBUS; no intellectual property right or licence is granted by AIRBUS in connection with any information contained in it. It is delivered on the express condition that said document and the information contained in it shall be treated as confidential, shall not be used for any purpose other than that for which it is hereby delivered. It shall not be disclosed in whole or in part to third parties and shall not be duplicated in any manner (except for the purposes of performing the tasks described hereunder and provided that any recipient of such document shall comply with the conditions herein), without AIRBUS prior written consent.

### **1. PLANNING INFORMATION**

**\*\*CONF ALL**

#### **A. EFFECTIVITY**

**NOTE:** This modification is applicable by Service Bulletin only.

**NOTE:** This Service Bulletin is only applicable to aircraft listed below on which Mod. No. 201609S31961 (INSTALL A NEW CONIC PLATE FOR NEW AOA (ANGLE OF ATTACK SENSOR) THALES) or Mod. No. 201610S31887 (INSTALL A NEW CONIC PLATE FOR NEW AOA (ANGLE OF ATTACK SENSOR) GOODRICH AND OLD THALES) are embodied or on which Service Bulletin No. A340-34-5081 is accomplished.

(1) Models

340-541 340-542 340-642

(2) Effectivity by MSN

0371 0376 0383 0391 0394 0410 0416-0417 0426 0431 0436 0440 0445 0449 0453  
0457 0460 0464 0468 0471 0475 0478 0482 0485 0488 0492 0495 0499 0514 0517  
0520 0523 0531 0534 0537 0540 0543 0547 0557 0560 0563 0566 0569 0572 0575  
0577 0580 0583 0586 0601 0604 0606 0608 0611 0615 0617 0619 0622 0624 0626  
0628 0630 0639 0672 0677 0681 0685 0689 0694 0698 0702 0706 0710 0715 0719  
0723 0727 0736 0740 0744 0748 0753 0757 0761-0768 0771 0775 0779 0783 0787

5 DATE: Jan 30/13

SERVICE BULLETIN No.: A340-34-5093

REVISION No.: 00 - Jan 30/13

Page: 1

## SERVICE BULLETIN

0790 0794 0798 0804 0812 0829 0837 0846 0848 0870 0886 0894 0897 0902 0910  
0912 0917 0924 0929 0933 0953 0960 0972 0981 0987 0993 1005 1017 1030 1040  
1079 1091 1102 1122

(3) Effectivity by Operator

The Operator/MSN relationship is provided for information only and is correct at the time of issue in accordance with the information available to AIRBUS. Any future changes resulting from transfer of an aircraft from one operator to another will not be reflected in this list unless the Service Bulletin is revised for another reason.

| OPERATOR | MSN  |
|----------|--|
| 06U      | 1091 1102  |
| 25R      | 0924   |
| 36V      | 0391 0416  |
| 62X      | 0779   |
| 70U      | 0902   |
| 72W      | 0917   |
| AHY      | 0886 0894  |
| CES      | 0468 0488 0514 0577 0586   |
| CHH      | 0436 0453 0475   |
| DLH      | 0482 0517 0523 0537 0540 0543 0566 0569 0580 0583 0762 0763<br>0767 0771 0790 0794 0812 0846 0848 0897 0972 0981 0987 1005 |
| ETD      | 0748 0757 0761 0783 0829 0837 0870 0929 0933 1030 1040   |
| HFY      | 0910 0912  |
| IBE      | 0431 0440 0460 0601 0604 0606 0617 0619 0672 0702 0727 0744<br>0960 0993 1017 1079 1122                                    |
| QAF      | 0495   |
| QTR      | 0715 0740 0766 0798  |
| SAA      | 0410 0417 0426 0531 0534 0547 0557 0626 0630   |
| SIA      | 0478 0492 0499 0560 0563   |
| TAM      | 0445 0464  |
| THA      | 0624 0628 0677 0681 0689 0698 0710 0719 0775 0953  |
| UAE      | 0394 0457 0471 0485 0520 0572 0608 0611 0685 0694  |
| VIR      | 0371 0376 0383 0449 0575 0615 0622 0639 0706 0723 0736 0753<br>0764 0765 0768 0787 0804                                    |

(4) Configuration by MSN

| MSN                           | CONFIGURATION |
|-------------------------------|---------------|
| 0371 0376 0383 0391 0416 0449 | 001           |

| MSN  | CONFIGURATION |
|--|---------------|
| 0394 0410 0417 0426 0431 0436 0440 0445 0453 0457 0460 | 002           |
| 0464 0468 0471 0475 0478 0482 0485 0488 0492 0495 0499 |               |
| 0514 0517 0520 0523 0531 0534 0537 0540 0543 0547 0557 |               |
| 0560 0563 0566 0569 0572 0575 0577 0580 0583 0586 0601 |               |
| 0604 0606 0608 0611 0615 0617 0619 0622 0624 0626 0628 |               |
| 0630 0639 0672 0677 0681 0685 0689 0694 0698 0702 0706 |               |
| 0710 0715 0719 0723 0727 0736 0740 0744 0748 0753 0757 |               |
| 0761 0762 0763 0764 0765 0766 0767 0768 0771 0775 0779 |               |
| 0783 0787 0790 0794 0798 0804 0812 0829 0837 0846 0848 |               |
| 0870 0886 0894 0897 0902 0910 0912 0917 0924 0929 0933 |               |
| 0953 0960 0972 0981 0987 0993 1005 1017 1030 1040 1079 |               |
| 1091 1102 1122   |               |

(5) Configuration definition

**\*\*CONF 001**

Config. 001 is valid for aircraft on which Mod. No. 50648D44169 is not embodied.

**\*\*CONF 002**

Config. 002 is valid for aircraft on which Mod. No. 50648D44169 is embodied.

(6) Material Effectivity

| MATERIAL          | QTY PER A/C | SEE NOTES |
|-------------------|-------------|-----------|
| Consumable CMLA01 | 1           |           |
| Component COMPA01 | 1           |           |
| Component COMPA02 | 1           |           |

**B. CONCURRENT REQUIREMENTS**

None

**C. REASON**

(1) History

Following a recent in-service event, as a precautionary measure, Airbus requires to suspend the installation of the AOA (Angle Of Attack) conic plates as per Operator Information Transmission (OIT) No. 999.0086/12, currently performed through an Airbus monitored campaign with Service Bulletin No. A340-34-5081.

(2) Objective/Action

This modification requires the removal of the conic plates PN F3411060200000 and PN F3411060900000, and the installation of flat plates PN F3411007920200 (LH) / PN F3411007920300 (RH).

Also, it requires to change the 3 AOA Sensor Protection Covers (FINs 7955ME, 7956ME and 7957ME) stored in Flight Kit No 2 (FIN 7500NW or FIN 7503NW).

## (3) Advantages

Refer to OIT No. 999.0086/12 and FOT No. 999.0089/12 for further explanations.

## (4) Operational/Maintenance Consequences

For aircraft already fitted with the AOA conic plates through retrofit or from production, Airbus released associated operational recommendations in an FOT No. 999.0089/12, the Operations Engineering Bulletin (OEB) 45 and Flight Manual (FM) Temporary Revision 294.

This Service Bulletin modifies the Ground System Equipment (the AOA Protection Covers) needed for parking, mooring or storing the aircraft.

Accomplishment of this Service Bulletin cancels OEB 45 and FM TR294. It is expected that an Airworthiness Directive (AD) published by the European Aviation Safety Agency (EASA) will be issued to confirm this cancellation.

This Service Bulletin modifies the Ground System Equipment (the AOA Protection Covers) needed for parking, mooring or storing the aircraft.

The operational consequence of this Service Bulletin is the modification of the Flight Manual (FM) and Flight Crew Operating Manual (FCOM) by removing temporary operational measures introduced by OEB 45, FOT No. 999.0089/12 and FM TR294.

**D. DESCRIPTION**

To accomplish this Service Bulletin it is necessary to :

**\*\*CONF 001**

Task 345093-831-801-001: Modification of the AOA sensor plates.

- (1) Replace the Conic Plate of the AOA Sensor FIN 3FP1, on the LH Side.
- (2) Replace the Conic Plates of the AOA Sensors FINs 3FP2 and 3FP3, on the RH Side.
- (3) Replace the AOA Protection Covers in the Flight Kit No 2 (FIN 7500NW).

**\*\*CONF 002**

Task 345093-831-801-001: Modification of the AOA sensor plates.

- (1) Replace the Conic Plate of the AOA Sensor FIN 3FP1, on the LH Side.
- (2) Replace the Conic Plates of the AOA Sensors FINs 3FP2 and 3FP3, on the RH Side.
- (3) Replace the AOA Protection Covers in the Flight Kit No 2 (FIN 7503NW).

### **\*\*CONF ALL**

#### **E. COMPLIANCE**

- (1) Classification

MANDATORY: Service Bulletin must be accomplished.

- (2) Accomplishment Timescale

Accomplishment of this Service Bulletin must be done at the earliest opportunity where manpower and facilities are available but within 5 months from the initial Service Bulletin date.

This Service Bulletin has been classified Mandatory. It is expected that an Airworthiness Directive (AD) published by the European Aviation Safety Agency (EASA) will be issued to confirm this classification. It is anticipated that the AD will confirm the threshold given above but reference should be made to the AD for confirmation of the mandated accomplishment timescale.

#### **F. APPROVAL**

The technical content of this document is approved under the authority of Design Organisation Approval No. EASA.21J.031.

If an aircraft listed in the effectivity has a modification or repair embodied that is not of AIRBUS origin, and which affects the content of this Service Bulletin, the operator is responsible for obtaining approval by its airworthiness authority for any adaptation necessary before incorporation of the Service Bulletin.

#### **G. MANPOWER**

The manpower estimates given in this Service Bulletin are based on the direct labor cost to do the work. These estimates assume that the work will be done by experienced personnel, and may need to be revised upwards to suit operator's circumstances. The estimates do not include the time to prepare, plan or inspect the work. Manufacture and procurement of parts and tools, drying times for paints, sealants, etc., and general administration work are also not included.

### **\*\*CONF 001**

| Task 345093-831-801-001: Modification of the AOA sensor plates.                 |      |
|---|------|
| Get Access  | 0.50 |
| <b>On Aircraft</b>  |      |
| Replace the Conic Plate of the AOA Sensor FIN 3FP1, on the LH Side.             | 1.50 |
| Replace the Conic Plates of the AOA Sensors FINs 3FP2 and 3FP3, on the RH Side. | 3.00 |
| Replace the AOA Protection Covers in the Flight Kit No 2 (FIN 7500NW).          | 0.50 |
| Tests   | 0.25 |
| Close-Up  | 0.50 |

| Task 345093-831-801-001: Modification of the AOA sensor plates. |      |
|---|------|
| TOTAL MANHOURS  | 6.25 |
| ELAPSED TIME (HOURS)  | 4.25 |

NOTE: For detail concerning the elapsed time assumption, refer to APPENDIX 01: Elapsed Time Assumption .

**\*\*CONF 002**

| Task 345093-831-801-001: Modification of the AOA sensor plates.                 |      |
|---|------|
| Get Access  | 0.50 |
| <b>On Aircraft</b>  |      |
| Replace the Conic Plate of the AOA Sensor FIN 3FP1, on the LH Side.             | 1.50 |
| Replace the Conic Plates of the AOA Sensors FINs 3FP2 and 3FP3, on the RH Side. | 3.00 |
| Replace the AOA Protection Covers in the Flight Kit No 2 (FIN 7503NW).          | 0.50 |
| Tests   | 0.25 |
| Close-Up  | 0.50 |
| TOTAL MANHOURS  | 6.25 |
| ELAPSED TIME (HOURS)  | 4.25 |

NOTE: For detail concerning the elapsed time assumption, refer to APPENDIX 01: Elapsed Time Assumption .

**\*\*CONF ALL**

**H. WEIGHT AND BALANCE**

The weight and balance estimates given in this Service Bulletin are based on the Manufacturer's Empty Weight (MEW) and do not include operator item's. For the definition of (MEW) and operator's items refer to Weight and Balance Manual (WBM) Chapter 1-00-07.

|                            |            |                  |
|----------------------------|------------|------------------|
| Manufacturers Empty Weight | -0.549 KG  | (-1.2103 LB)     |
| Effect on Balance          | -7.502 KGM | (-54.262 LB.FT ) |

**I. ELECTRICAL LOAD DATA**

Not Changed

**J. REFERENCES**

**\*\*CONF 001**

|  |          |          |          |
|--|----------|----------|----------|
| Aircraft Maintenance Manual (AMM)                    | 06-20-00 | 06-31-53 | 06-41-53 |
|  | 12-34-24 | 20-21-11 | 20-28-00 |
|  | 52-30-00 | 52-41-00 |          |
| Consumable Material List (CML)                       |          |          |          |
| ATA Common Support Data Dictionary (CSDD), Chapter 2 |          |          |          |

|                                     |                 |          |          |
|-------------------------------------|-----------------|----------|----------|
| Elec. Std. Practices Manual (ESPM)  | 20-51-20        | 20-55-00 |          |
| Flight Crew Operating Manual (FCOM) |                 |          |          |
| Flight Manual (FM)                  |                 |          |          |
| Standards Manual (SM)               |                 |          |          |
| Structural Repair Manual (SRM)      | 51-24-00        | 51-42-00 | 51-43-00 |
| Weight and Balance Manual (WBM)     | Chapter 1-00-07 |          |          |

**\*\*CONF 002**

|  |                 |          |          |
|--|-----------------|----------|----------|
| Aircraft Maintenance Manual (AMM)                    | 06-20-00        | 06-31-53 | 06-41-53 |
|  | 12-34-24        | 20-21-11 | 20-28-00 |
|  | 52-30-00        | 52-41-00 |          |
| Consumable Material List (CML)                       |                 |          |          |
| ATA Common Support Data Dictionary (CSDD), Chapter 2 |                 |          |          |
| Elec. Std. Practices Manual (ESPM)                   | 20-51-20        | 20-55-00 |          |
| Flight Crew Operating Manual (FCOM)                  |                 |          |          |
| Flight Manual (FM)                                   |                 |          |          |
| Standards Manual (SM)                                |                 |          |          |
| Structural Repair Manual (SRM)                       | 51-24-00        | 51-42-00 | 51-43-00 |
| Weight and Balance Manual (WBM)                      | Chapter 1-00-07 |          |          |

**\*\*CONF ALL**

**K. PUBLICATION AFFECTED**

|                                     |          |          |          |
|-------------------------------------|----------|----------|----------|
| Aircraft Maintenance Manual (AMM)   | 10-11-00 | 12-21-11 | 34-11-19 |
| Aircraft Wiring List (AWL)          |          |          |          |
| Flight Crew Operating Manual (FCOM) |          |          |          |
| Flight Manual (FM)                  |          |          |          |
| Illustrated Parts Catalog (IPC)     | 25-73-04 | 34-11-01 |          |
| Tool Equipment Manual (TEM)         | 10-11-00 |          |          |

This Service Bulletin has an operational impact. Please inform AIRBUS, at least four weeks in advance, in case you need your operational documentation to be amended by a revision prior to Service Bulletin embodiment. For this purpose, please request the revision by e-mail, on-line through the SB Reporting service or alternatively by fax to:

SEDOR4, AIRBUS  
 Customer Services Technical Data  
 Fax No.: (33) 5 61 93 28 06  
 E-mail: sb.reporting@airbus.com

SB Reporting service is accessible on-line through AIRBUSWorld from:

- 'My on-line services' section, available on all AIRBUSWorld pages
- The Maintenance & Engineering Community, in:
  - . Modify and Upgrade page - Access SB and VSB section.

These amendments will be confirmed by the next normal revision of operational documentation, once your Service Bulletin accomplishment report has been sent, as usual, to our Customer Services Aircraft In-Service Data (SEDOR4).

### **L. INTERCHANGEABILITY/MIXABILITY**

#### **\*\*CONF 001**

| DESCRIPTION                 | OLD PART N°    | NEW PART N°    | INT | MIXABILITY | SEE NOTES |
|-----------------------------|----------------|----------------|-----|------------|-----------|
| Plate                       | F3411060900000 | F3411007920200 | 01  | NO         |           |
| Plate                       | F3411060200000 | F3411007920200 | 01  | NO         |           |
| AOA Sensor Protection Cover | 98D34203003000 | 98F10001000000 | 01  | NO         |           |
| Plate                       | F3411060200000 | F3411007920300 | 01  | NO         |           |
| Plate                       | F3411060900000 | F3411007920300 | 01  | NO         |           |

NOTE: For definitions of interchangeability codes in column INT., refer to ATA Common Support Data Dictionary (CSDD), Chapter 2.

NOTE: Only the mixability configuration(s) and condition(s) stated in this Service Bulletin are approved.

#### **\*\*CONF 002**

| DESCRIPTION                 | OLD PART N°    | NEW PART N°    | INT | MIXABILITY | SEE NOTES |
|-----------------------------|----------------|----------------|-----|------------|-----------|
| Plate                       | F3411060900000 | F3411007920200 | 01  | NO         |           |
| Plate                       | F3411060200000 | F3411007920200 | 01  | NO         |           |
| AOA Sensor Protection Cover | 98D34203003000 | 98F10001000000 | 01  | NO         |           |
| Plate                       | F3411060200000 | F3411007920300 | 01  | NO         |           |
| Plate                       | F3411060900000 | F3411007920300 | 01  | NO         |           |

NOTE: For definitions of interchangeability codes in column INT., refer to ATA Common Support Data Dictionary (CSDD), Chapter 2.

NOTE: Only the mixability configuration(s) and condition(s) stated in this Service Bulletin are approved.

#### **\*\*CONF ALL**

### **M. SPARES**

AOA Sensor Protection Cover 98D34203003000  
Plate F3411060200000  
Plate F3411060900000



### 2. MATERIAL INFORMATION

**\*\*CONF ALL**

#### A. MATERIAL - PRICE AND AVAILABILITY

(1) Procurement Addresses

This Service Bulletin is the subject of an AIRBUS monitored retrofit campaign.

|                   |   |
|-------------------|---|
| Component COMPA01 | Customers with aircraft shown in the effectivity of this Service Bulletin should send a purchase order to AIRBUS. Quote the number of this Service Bulletin. The address is:<br>AIRBUS Material, Logistics and Suppliers<br>IFD - In Flight Desk<br>Weg beim Jaeger 150<br>D-22335 HAMBOURG<br>GERMANY<br>For ordering by internet:<br><a href="http://spares.airbus.com">http://spares.airbus.com</a><br>For ordering by fax: +49 40 50 76 4012<br>For ordering by E-mail:<br><a href="mailto:ifd.spares@airbus.com">ifd.spares@airbus.com</a> |
|-------------------|---|

|                   |  |
|-------------------|--|
| Component COMPA02 | Airbus Material, Logistics and Suppliers do not stock standard hardware as competitive multiple suppliers ensure access to minimum prices Airbus recommends Customers with aircraft shown in the effectivity of this Service Bulletin to send a purchase order to B/E Aerospace. The address is:<br>B/E AEROSPACE INC<br>CONSUMABLES MANAGEMENT<br>10000 NW 15TH Terrace Miami<br>FL 33172<br>USA<br>Tel EMEA: +49 (0) 40 822 285 31500<br>Tel US: +1 305 925 2600<br>Tel ASIA: +1 310 900 1300<br>Fax EMEA: +49 (0) 40 822 285 31010<br>Fax US: +1 305 507 7191<br>Fax ASIA: +1 310 819 1200<br>SITA: MIAMMCR<br>E-Mail: <a href="mailto:AOGdesk_CMG@beaerospace.com">AOGdesk_CMG@beaerospace.com</a><br>internet: <a href="http://www.beconsumables.com">www.beconsumables.com</a><br>or, alternatively any other source on the open market. |
|-------------------|--|

(2) Price and Availability

No AIRBUS kit will be provided.

Operator supplied AIRBUS parts required to accomplish this Service Bulletin are to be purchased by a spares purchase order.

Operator supplied standard hardware parts required to accomplish this Service Bulletin are to be supplied from the Operator's stock.

**B. INDUSTRY SUPPORT INFORMATION**

AIRBUS will share the costs of accomplishment of this Service Bulletin by crediting the operator supplied AIRBUS parts for orders placed before Jun 30/13. Claims for this allowance should be received not later than 90 days after completion of the last affected aircraft of your fleet.

For the accomplishment of this Service Bulletin before Jun 30/13, AIRBUS will credit the manhours indicated in this Service Bulletin at the agreed in-house warranty labor rate for claims received not later than 90 days after completion of the last affected aircraft of your fleet.

For the organisation of this retrofit, you are kindly requested to contact AIRBUS retrofit management department.

AIRBUS  
CUSTOMER SERVICES DIRECTORATE  
1 Rond Point Maurice Bellonte  
31707 BLAGNAC CEDEX  
France  
Tel : (33) 5 67 19 06 22  
E-mail : monitored.retrofit@airbus.com  
Fax : (33) 5 61 93 27 45

**C. LIST OF COMPONENTS**

No Kit

**D. LIST OF MATERIALS - OPERATOR SUPPLIED**

(1) Consumable Materials

Consumable CMLA01

| ITEM | DESCRIPTION                                 | REFERENCE TO CML<br>MAT. No. | QTY PER A/C | SEE<br>NOTES |
|------|---|------------------------------|-------------|--------------|
|      | Release Agent (obsolete Use<br>05-013a)     | 05-013                       | As required |              |
|      | Corrosion Inhibitingfillet Consistency      | 09-016                       | As required |              |
|      | Fuel Tank Sealant Quick Repair<br>Permanent | 09-058                       | As required |              |
|      | Solvent General Purpose                     | 11-026                       | As required |              |

### (2) Components

#### Component COMPA01

| ITEM | NEW PART N°    | QTY (UM) | KEYWORD  | ITEM | OLD PART N°    | INT | SEE NOTES |
|------|----------------|----------|----------|------|----------------|-----|-----------|
| 2    | F3411007920200 | 1        | PLATE    | (2)  | F3411060200000 | 01  |           |
|      |                |          |          | (2)  | F3411060900000 | 01  |           |
| 2    | F3411007920300 | 2        | PLATE    | (2)  | F3411060200000 | 01  |           |
|      |                |          |          | (2)  | F3411060900000 | 01  |           |
|      | 98F10001000000 | 3        | AOAPRTCT |      | 98D34203003000 | 01  |           |

NOTE: For definitions of interchangeability codes in column INT., refer to ATA Common Support Data Dictionary (CSDD), Chapter 2.

NOTE: The above list of components is not an AIRBUS Kit, the required parts shall be ordered as necessary through the given channel.

#### Component COMPA02

| ITEM | NEW PART N°  | QTY (UM) | KEYWORD | ITEM | OLD PART N° | INT | SEE NOTES |
|------|--------------|----------|---------|------|-------------|-----|-----------|
| 1    | NAS1102-3-14 | 21       | SCREW   |      |             |     |           |

NOTE: If you find part numbers of hardware components in the related kit(s) which you cannot identify in the LIST OF COMPONENTS of this Service Bulletin, refer to Standards Manual (SM). The SM will give you the correct part number to part number relationship.

NOTE: The above list of components is not an AIRBUS Kit, the required parts shall be ordered as necessary through the given channel.

### (3) Equipment

None

#### **E. PARTS TO BE RE-IDENTIFIED BY OPERATOR**

None

#### **F. TOOLING**

None

This Page Intentionally Left Blank

### 3. ACCOMPLISHMENT INSTRUCTIONS

**Task 345093-831-801-001 - Modification of the AOA sensor plates.**

**WARNING:** MAKE SURE THAT YOU OBEY ALL THE WARNINGS AND ALL THE CAUTIONS INCLUDED IN THE REFERENCED PROCEDURES.

**CAUTION:** ALWAYS OBEY THE PRECAUTIONS THAT FOLLOW TO KEEP ELECTRICAL WIRING IN A SATISFACTORY CONDITION (ELECTRICALLY AND MECHANICALLY SERVICEABLE). WHEN YOU DO MAINTENANCE WORK, REPAIRS OR MODIFICATIONS, ALWAYS KEEP ELECTRICAL WIRING, COMPONENTS AND THE WORK AREA AS CLEAN AS POSSIBLE. TO DO THIS:

- PUT PROTECTION, SUCH AS PLASTIC SHEETING, CLOTHS, ETC; AS NECESSARY ON WIRING AND COMPONENTS.
- REGULARLY REMOVE ALL SHAVINGS, UNWANTED MATERIAL AND OTHER CONTAMINATION.

THESE PRECAUTIONS WILL DECREASE THE RISK OF CONTAMINATION AND DAMAGE TO THE ELECTRICAL WIRING INSTALLATION.

IN CASE OF CONTAMINATION REFER TO ESPM 20-55-00.

#### Task Associated Data

##### \*\*CONF 001

|                             |                 |
|-----------------------------|-----------------|
| Zone                        |                 |
| 121 122 160                 |                 |
| Modified FIN                |                 |
| 7955ME 7956ME 7957ME 7500NW |                 |
| Access                      |                 |
| Door                        | 823             |
| Other access                | Access platform |
| Manpower                    |                 |
| TOTAL MANHOURS              | 6.25            |
| ELAPSED TIME (HOURS)        | 4.25            |

##### \*\*CONF 002

|                             |                 |
|-----------------------------|-----------------|
| Zone                        |                 |
| 121 122 130                 |                 |
| Modified FIN                |                 |
| 7955ME 7956ME 7957ME 7503NW |                 |
| Access                      |                 |
| Door                        | 821             |
| Other access                | Access platform |

| Manpower             |      |
|----------------------|------|
| TOTAL MANHOURS       | 6.25 |
| ELAPSED TIME (HOURS) | 4.25 |

**\*\*CONF ALL**

**A. GENERAL**

**\*\*CONF 001**

**(1) Subtask 345093-910-001-001 - Standard Practices**

| Manpower Resources |              |
|--------------------|--------------|
| Skills             | NON SPECIFIC |

| References                         |   |
|------------------------------------|---|
| Aircraft Maintenance Manual (AMM)  | 06-20-00, Page Block 001<br>06-31-53, Page Block 001<br>Task 20-21-11-911-801<br>Task 20-28-00-912-802<br>Task 20-28-00-912-805 |
| Consumable Material List (CML)     |   |
| Elec. Std. Practices Manual (ESPM) | 20-51-20  |
| Structural Repair Manual (SRM)     | 51-24-00<br>51-42-00<br>51-43-00  |

- (a) For the specification of materials (Mat. No.) given in this Service Bulletin, refer to Consumable Materials List (CML).
- (b) For the Frame (FR) identification, refer to AMM 06-31-53, Page Block 001.
- (c) For the identification of zones, refer to AMM 06-20-00, Page Block 001.
- (d) To torque tighten the standard threaded fasteners, refer to AMM Task 20-21-11-911-801.
- (e) Remove and install fasteners in accordance with SRM 51-42-00.
- (f) Obtain alternative and substitute fasteners data, in accordance with SRM 51-43-00.
- (g) If the length of any fastener specified in this Service Bulletin does not meet installation standards given in SRM Chapter 51, then a fastener of the same specification, or an approved substitute, with a length which meets the installation standards given in SRM Chapter 51 may be used. In addition, washers may be installed for fastener grip length in accordance with SRM Chapter 51.
- (h) For the electrical bonding, refer to ESPM 20-51-20 and AMM Task 20-28-00-912-802 and/or AMM Task 20-28-00-912-805.
- (i) Apply sealant in accordance with SRM 51-24-00.

### (2) Subtask 345093-839-001-001 - Administrative

| Manpower Resources |              |
|--------------------|--------------|
| Skills             | NON SPECIFIC |

- (a) Write in the applicable aircraft records that you have done all the work given in this Service Bulletin.

### \*\*CONF 002

### (1) Subtask 345093-910-001-001 - Standard Practices

| Manpower Resources |              |
|--------------------|--------------|
| Skills             | NON SPECIFIC |

| References                         |   |
|------------------------------------|---|
| Aircraft Maintenance Manual (AMM)  | 06-20-00, Page Block 001<br>06-31-53, Page Block 001<br>Task 20-21-11-911-801<br>Task 20-28-00-912-802<br>Task 20-28-00-912-805 |
| Consumable Material List (CML)     |   |
| Elec. Std. Practices Manual (ESPM) | 20-51-20  |
| Structural Repair Manual (SRM)     | 51-24-00<br>51-42-00<br>51-43-00  |

- (a) For the specification of materials (Mat. No.) given in this Service Bulletin, refer to Consumable Materials List (CML).
- (b) For the Frame (FR) identification, refer to AMM 06-31-53, Page Block 001.
- (c) For the identification of zones, refer to AMM 06-20-00, Page Block 001.
- (d) To torque tighten the standard threaded fasteners, refer to AMM Task 20-21-11-911-801.
- (e) Remove and install fasteners in accordance with SRM 51-42-00.
- (f) Obtain alternative and substitute fasteners data, in accordance with SRM 51-43-00.
- (g) If the length of any fastener specified in this Service Bulletin does not meet installation standards given in SRM Chapter 51, then a fastener of the same specification, or an approved substitute, with a length which meets the installation standards given in SRM Chapter 51 may be used. In addition, washers may be installed for fastener grip length in accordance with SRM Chapter 51.
- (h) For the electrical bonding, refer to ESPM 20-51-20 and AMM Task 20-28-00-912-802 and/or AMM Task 20-28-00-912-805.
- (i) Apply sealant in accordance with SRM 51-24-00.

### (2) Subtask 345093-839-001-001 - Administrative

| Manpower Resources |              |
|--------------------|--------------|
| Skills             | NON SPECIFIC |

- (a) Write in the applicable aircraft records that you have done all the work given in this Service Bulletin.

**\*\*CONF ALL**

### B. PREPARATION

**\*\*CONF 001**

#### (1) Subtask 345093-941-001-001 - Job Set-up

| Manpower Resources |              |
|--------------------|--------------|
| Skills             | NON SPECIFIC |

| References                        |  |
|-----------------------------------|--|
| Aircraft Maintenance Manual (AMM) | 06-41-53, Page Block 001<br>Task 12-34-24-860-802<br>Task 52-30-00-010-803<br>52-41-00, Page Block 001 |

- (a) Make sure that the aircraft is electrically grounded, refer to AMM Task 12-34-24-860-802.
- (b) Put the access platforms in position at the Bulk cargo-compartment door 823, at avionics compartment door 811 and at zone 121 to get access to the AOA sensor FIN 3FP1 and at zone 122 to get access to the AOA sensors FINs 3FP2 and 3FP3.
- (c) Open the Bulk cargo-compartment door 823, refer to AMM Task 52-30-00-010-803.
- (d) Open the avionics compartment door 811, refer to AMM 52-41-00, Page Block 001 and AMM 06-41-53, Page Block 001.
- (e) Safety precaution
- 1 On the panel 225VU:
- a Make sure that the PROBE/WINDOW HEAT pushbutton switch is released (the ON legend is OFF).

**\*\*CONF 002**

#### (1) Subtask 345093-941-001-002 - Job Set-up

| Manpower Resources |              |
|--------------------|--------------|
| Skills             | NON SPECIFIC |



| References                        |  |
|-----------------------------------|--|
| Aircraft Maintenance Manual (AMM) | 06-41-53, Page Block 001<br>Task 12-34-24-860-802<br>Task 52-30-00-010-801<br>52-41-00, Page Block 001 |

- (a) Make sure that the aircraft is electrically grounded, refer to AMM Task 12-34-24-860-802.
- (b) Put the access platform(s) in position at the FWD cargo-compartment door 821, at avionics compartment door 811 and at zones 121 to get access to the AOA sensor FIN 3FP1 and zone 122 to get access to the AOA sensors FINs 3FP2 and 3FP3.
- (c) Open the FWD cargo-compartment door 821, refer to AMM Task 52-30-00-010-801.
- (d) Open the avionics compartment door 811, refer to AMM 52-41-00, Page Block 001 and AMM 06-41-53, Page Block 001.
- (e) Safety precaution
  - 1 On the panel 225VU:
    - a Make sure that the PROBE/WINDOW HEAT pushbutton switch is released (the ON legend is OFF).

**\*\*CONF ALL**

**C. PROCEDURE**

**\*\*CONF 001**

- (1) Subtask 345093-831-001-001 - Replace the Conic Plate of the AOA Sensor FIN 3FP1, on the LH Side.**

| Work Zones and Access Panels |      |                      |                              |
|------------------------------|------|----------------------|------------------------------|
|                              | Zone | Access/Work location |                              |
|                              | 121  | Access               | Other access Access platform |

| Manpower Resources       |              |
|--------------------------|--------------|
| Manhours                 | 1.50         |
| Minimum number of person | 1            |
| Subtask elapsed time     | 1.50         |
| Skills                   | NON SPECIFIC |

Material necessary to do the job

| Component COMPA01 |                |          |         |           |
|-------------------|----------------|----------|---------|-----------|
| ITEM              | NEW PART N°    | QTY (UM) | KEYWORD | SEE NOTES |
| 2                 | F3411007920200 | 1        | PLATE   |           |

## SERVICE BULLETIN

**NOTE:** The above list of components is not an AIRBUS Kit, the required parts shall be ordered as necessary through the given channel.

| Component COMPA02 |              |          |         |           |
|-------------------|--------------|----------|---------|-----------|
| ITEM              | NEW PART N°  | QTY (UM) | KEYWORD | SEE NOTES |
| 1                 | NAS1102-3-14 | 7        | SCREW   |           |

**NOTE:** The above list of components is not an AIRBUS Kit, the required parts shall be ordered as necessary through the given channel.

| Consumable CMLA01 |                         |                           |             |           |
|-------------------|-------------------------|---------------------------|-------------|-----------|
| ITEM              | DESCRIPTION             | REFERENCE TO CML MAT. No. | QTY PER A/C | SEE NOTES |
|                   | Solvent General Purpose | 11-026                    | As required |           |

| References                                 |  |
|--|--|
| Structural Repair Manual (SRM)             | 51-42-00<br>51-43-00                                 |
| Fig. A-FBAAA<br>Modification of the Plates | <a href="#">Sheet 01</a><br><a href="#">Sheet 02</a> |

**NOTE:** The screw item (3) must not be removed to keep the AOA sensor in position and to avoid removing it.

(a) Replace the conic plate by the flat plate of the AOA Sensor FIN 3FP1:

**NOTE:** Make sure that the previous plate installed on the aircraft is a conic plate. Refer to aircraft maintenance records.

In accordance with SRM 51-42-00 and SRM 51-43-00

1 Use a non-metallic spatula to remove the sealant and clean the areas with:

|                         |        |             |
|-------------------------|--------|-------------|
| Solvent General Purpose | 11-026 | As required |
|-------------------------|--------|-------------|

2 Remove the conic plate:

Refer to [Fig. A-FBAAA Sheet 01](#)

|   |       |                |          |         |
|---|-------|----------------|----------|---------|
| 1 | Plate | F3411060200000 | Item (2) | Discard |
|---|-------|----------------|----------|---------|

or

|   |       |                |          |         |
|---|-------|----------------|----------|---------|
| 1 | Plate | F3411060900000 | Item (2) | Discard |
|---|-------|----------------|----------|---------|

attached with:

|   |       |  |          |         |
|---|-------|--|----------|---------|
| 7 | Screw |  | Item (1) | Discard |
|---|-------|--|----------|---------|

3 Use a non-metallic spatula to remove the sealant and clean the areas with:

|                         |        |             |
|-------------------------|--------|-------------|
| Solvent General Purpose | 11-026 | As required |
|-------------------------|--------|-------------|

4 Install the flat plate:

**CAUTION:** NEW AOA FLAT PLATE SHALL NOT BE PAINTED AND SHALL REMAIN AS DELIVERED.

**NOTE:** The attaching holes of the flat plates are delivered stripped from protection at level of the surface of the bonding areas.

Refer to [Fig. A-FBAAA Sheet 02](#)

1 Plate F3411007920200 Item 2

attached with:

7 Screw NAS1102-3-14 Item 1

**(2) Subtask 345093-831-002-001 - Replace the Conic Plates of the AOA Sensors FINs 3FP2 and 3FP3, on the RH Side.**

| Work Zones and Access Panels |      |                      |                              |
|------------------------------|------|----------------------|------------------------------|
|                              | Zone | Access/Work location |                              |
|                              | 122  | Access               | Other access Access platform |

| Manpower Resources       |              |
|--------------------------|--------------|
| Manhours                 | 3.00         |
| Minimum number of person | 1            |
| Subtask elapsed time     | 3.00         |
| Skills                   | NON SPECIFIC |

Material necessary to do the job

| Component COMPA01 |                |          |         |           |
|-------------------|----------------|----------|---------|-----------|
| ITEM              | NEW PART N°    | QTY (UM) | KEYWORD | SEE NOTES |
| 2                 | F3411007920300 | 2        | PLATE   |           |

**NOTE:** The above list of components is not an AIRBUS Kit, the required parts shall be ordered as necessary through the given channel.

| Component COMPA02 |              |          |         |           |
|-------------------|--------------|----------|---------|-----------|
| ITEM              | NEW PART N°  | QTY (UM) | KEYWORD | SEE NOTES |
| 1                 | NAS1102-3-14 | 14       | SCREW   |           |

**NOTE:** The above list of components is not an AIRBUS Kit, the required parts shall be ordered as necessary through the given channel.

| Consumable CMLA01 |                         |                           |             |           |
|-------------------|-------------------------|---------------------------|-------------|-----------|
| ITEM              | DESCRIPTION             | REFERENCE TO CML MAT. No. | QTY PER A/C | SEE NOTES |
|                   | Solvent General Purpose | 11-026                    | As required |           |

| References                                 |  |
|--|--|
| Structural Repair Manual (SRM)             | 51-42-00<br>51-43-00                                 |
| Fig. A-FBAAA<br>Modification of the Plates | <a href="#">Sheet 01</a><br><a href="#">Sheet 02</a> |

**NOTE:** The screw item (3) must not be removed to keep the AOA sensors in position and to avoid removing them.

- (a) Replace the conic plates by the flat plates of the AOA Sensors FINs 3FP2 and 3FP3:

**NOTE:** Make sure that the previous plate installed on the aircraft is a conic plate. Refer to aircraft maintenance records.

In accordance with SRM 51-42-00 and SRM 51-43-00

- 1 Use a non-metallic spatula to remove the sealant and clean the areas with:

|                         |        |             |
|-------------------------|--------|-------------|
| Solvent General Purpose | 11-026 | As required |
|-------------------------|--------|-------------|

- 2 Remove the conic plates:

Refer to [Fig. A-FBAAA Sheet 01](#)

|   |       |                |          |         |
|---|-------|----------------|----------|---------|
| 2 | Plate | F3411060200000 | Item (2) | Discard |
|---|-------|----------------|----------|---------|

or

|   |       |                |          |         |
|---|-------|----------------|----------|---------|
| 2 | Plate | F3411060900000 | Item (2) | Discard |
|---|-------|----------------|----------|---------|

attached with:

|    |      |  |          |         |
|----|------|--|----------|---------|
| 14 | Srew |  | Item (1) | Discard |
|----|------|--|----------|---------|

- 3 Use a non-metallic spatula to remove the sealant and clean the areas with:

|                         |        |             |
|-------------------------|--------|-------------|
| Solvent General Purpose | 11-026 | As required |
|-------------------------|--------|-------------|

- 4 Install the flat plates:

**CAUTION:** NEW AOA FLAT PLATES SHALL NOT BE PAINTED AND SHALL REMAIN AS DELIVERED.

**NOTE:** The attaching holes of the flat plates are delivered stripped from protection at level of the surface of the bonding areas.

Refer to [Fig. A-FBAAA Sheet 02](#)

2 Plate F3411007920300 Item 2

attached with:

14 Screw NAS1102-3-14 Item 1

**(3) Subtask 345093-831-003-001 - Replace the AOA Protection Covers in the Flight Kit No 2 (FIN 7500NW).**

| Work Zones and Access Panels |      |                      |          |
|------------------------------|------|----------------------|----------|
|                              | Zone | Access/Work location |          |
|                              | 160  | Access               | Door 823 |

| Manpower Resources       |              |
|--------------------------|--------------|
| Manhours                 | 0.50         |
| Minimum number of person | 1            |
| Subtask elapsed time     | 0.50         |
| Skills                   | NON SPECIFIC |

Material necessary to do the job

| Component COMPA01 |                |          |          |           |
|-------------------|----------------|----------|----------|-----------|
| ITEM              | NEW PART N°    | QTY (UM) | KEYWORD  | SEE NOTES |
|                   | 98F10001000000 | 3        | AOAPRTCT |           |

**NOTE:** The above list of components is not an AIRBUS Kit, the required parts shall be ordered as necessary through the given channel.

| References   |                          |
|--|--------------------------|
| Fig. A-FBBAA<br>Modification of AOA Protection Covers in the Flight Kit No 2 | <a href="#">Sheet 01</a> |

**NOTE:** Depending on airline internal policy the Flight Kit No 2 may not be located in the place defined by [Fig. A-FBBAA Sheet 01](#). Refer to airline internal policy for exact location for Flight Kit No 2 and/or its contents.

(a) Remove in the Flight Kit No 2 (FIN 7500NW):

Refer to [Fig. A-FBBAA Sheet 01](#):

- FIN 7955ME
- |   |   |         |
|---|---|---------|
| 1 | AOA Sensor Protection 98D34203003000<br>Cover | Discard |
|---|---|---------|
- FIN 7956ME
- |   |   |         |
|---|---|---------|
| 1 | AOA Sensor Protection 98D34203003000<br>Cover | Discard |
|---|---|---------|

FIN 7957ME

1 AOA Sensor Protection 98D34203003000 Cover Discard

(b) Install in the Flight Kit No 2 (FIN 7500NW):

[Fig. A-FBBAA Sheet 01:](#)

FIN 7955ME

1 AOA Sensor Protection 98F10001000000 Cover

FIN 7956ME

1 AOA Sensor Protection 98F10001000000 Cover

FIN 7957ME

1 AOA Sensor Protection 98F10001000000 Cover

**\*\*CONF 002**

**(1) Subtask 345093-831-001-001 - Replace the Conic Plate of the AOA Sensor FIN 3FP1, on the LH Side.**

| Work Zones and Access Panels |      |                      |                              |
|------------------------------|------|----------------------|------------------------------|
|                              | Zone | Access/Work location |                              |
|                              | 121  | Access               | Other access Access platform |

| Manpower Resources       |              |
|--------------------------|--------------|
| Manhours                 | 1.50         |
| Minimum number of person | 1            |
| Subtask elapsed time     | 1.50         |
| Skills                   | NON SPECIFIC |

Material necessary to do the job

| Component COMPA01 |                |          |         |           |
|-------------------|----------------|----------|---------|-----------|
| ITEM              | NEW PART N°    | QTY (UM) | KEYWORD | SEE NOTES |
| 2                 | F3411007920200 | 1        | PLATE   |           |

**NOTE:** The above list of components is not an AIRBUS Kit, the required parts shall be ordered as necessary through the given channel.

| Component COMPA02 |              |          |         |           |
|-------------------|--------------|----------|---------|-----------|
| ITEM              | NEW PART N°  | QTY (UM) | KEYWORD | SEE NOTES |
| 1                 | NAS1102-3-14 | 7        | SCREW   |           |

**NOTE:** The above list of components is not an AIRBUS Kit, the required parts shall be ordered as necessary through the given channel.

| Consumable CMLA01 |                         |                           |             |           |
|-------------------|-------------------------|---------------------------|-------------|-----------|
| ITEM              | DESCRIPTION             | REFERENCE TO CML MAT. No. | QTY PER A/C | SEE NOTES |
|                   | Solvent General Purpose | 11-026                    | As required |           |

| References                                 |  |
|--|--|
| Structural Repair Manual (SRM)             | 51-42-00<br>51-43-00                                 |
| Fig. A-FBAAA<br>Modification of the Plates | <a href="#">Sheet 01</a><br><a href="#">Sheet 02</a> |

**NOTE:** The screw item (3) must not be removed to keep the AOA sensor in position and to avoid removing it.

(a) Replace the conic plate by the flat plate of the AOA Sensor FIN 3FP1:

**NOTE:** Make sure that the previous plate installed on the aircraft is a conic plate. Refer to aircraft maintenance records.

In accordance with SRM 51-42-00 and SRM 51-43-00

1 Use a non-metallic spatula to remove the sealant and clean the areas with:

|                         |        |             |
|-------------------------|--------|-------------|
| Solvent General Purpose | 11-026 | As required |
|-------------------------|--------|-------------|

2 Remove the conic plate:

Refer to [Fig. A-FBAAA Sheet 01](#)

|   |       |                |          |         |
|---|-------|----------------|----------|---------|
| 1 | Plate | F3411060200000 | Item (2) | Discard |
|---|-------|----------------|----------|---------|

or

|   |       |                |          |         |
|---|-------|----------------|----------|---------|
| 1 | Plate | F3411060900000 | Item (2) | Discard |
|---|-------|----------------|----------|---------|

attached with:

|   |       |  |          |         |
|---|-------|--|----------|---------|
| 7 | Screw |  | Item (1) | Discard |
|---|-------|--|----------|---------|

3 Use a non-metallic spatula to remove the sealant and clean the areas with:

|                         |        |             |
|-------------------------|--------|-------------|
| Solvent General Purpose | 11-026 | As required |
|-------------------------|--------|-------------|

4 Install the flat plate:

**CAUTION:** NEW AOA FLAT PLATE SHALL NOT BE PAINTED AND SHALL REMAIN AS DELIVERED.

## SERVICE BULLETIN

**NOTE:** The attaching holes of the flat plates are delivered stripped from protection at level of the surface of the bonding areas.

Refer to [Fig. A-FBAAA Sheet 02](#)

1 Plate F3411007920200 Item 2

attached with:

7 Screw NAS1102-3-14 Item 1

**(2) Subtask 345093-831-002-001 - Replace the Conic Plates of the AOA Sensors FINs 3FP2 and 3FP3, on the RH Side.**

| Work Zones and Access Panels |      |                      |                              |
|------------------------------|------|----------------------|------------------------------|
|                              | Zone | Access/Work location |                              |
|                              | 122  | Access               | Other access Access platform |

| Manpower Resources       |              |
|--------------------------|--------------|
| Manhours                 | 3.00         |
| Minimum number of person | 1            |
| Subtask elapsed time     | 3.00         |
| Skills                   | NON SPECIFIC |

| Material necessary to do the job |
|----------------------------------|
|----------------------------------|

| Component COMPA01 |                |          |         |           |
|-------------------|----------------|----------|---------|-----------|
| ITEM              | NEW PART N°    | QTY (UM) | KEYWORD | SEE NOTES |
| 2                 | F3411007920300 | 2        | PLATE   |           |

**NOTE:** The above list of components is not an AIRBUS Kit, the required parts shall be ordered as necessary through the given channel.

| Component COMPA02 |              |          |         |           |
|-------------------|--------------|----------|---------|-----------|
| ITEM              | NEW PART N°  | QTY (UM) | KEYWORD | SEE NOTES |
| 1                 | NAS1102-3-14 | 14       | SCREW   |           |

**NOTE:** The above list of components is not an AIRBUS Kit, the required parts shall be ordered as necessary through the given channel.

| Consumable CMLA01 |                         |                           |             |           |
|-------------------|-------------------------|---------------------------|-------------|-----------|
| ITEM              | DESCRIPTION             | REFERENCE TO CML MAT. No. | QTY PER A/C | SEE NOTES |
|                   | Solvent General Purpose | 11-026                    | As required |           |

| References                     |                      |
|--------------------------------|----------------------|
| Structural Repair Manual (SRM) | 51-42-00<br>51-43-00 |





**(3) Subtask 345093-831-003-002 - Replace the AOA Protection Covers in the Flight Kit No 2 (FIN 7503NW).**

| Work Zones and Access Panels |      |                      |          |
|------------------------------|------|----------------------|----------|
|                              | Zone | Access/Work location |          |
|                              | 130  | Access               | Door 821 |

| Manpower Resources       |              |
|--------------------------|--------------|
| Manhours                 | 0.50         |
| Minimum number of person | 1            |
| Subtask elapsed time     | 0.50         |
| Skills                   | NON SPECIFIC |

Material necessary to do the job

| Component COMPA01 |                |          |          |           |
|-------------------|----------------|----------|----------|-----------|
| ITEM              | NEW PART N°    | QTY (UM) | KEYWORD  | SEE NOTES |
|                   | 98F10001000000 | 3        | AOAPRTCT |           |

**NOTE:** The above list of components is not an AIRBUS Kit, the required parts shall be ordered as necessary through the given channel.

| References   |                          |
|--|--------------------------|
| Fig. A-FBBAB<br>Modification of AOA Protection Covers in the Flight Kit No 2 | <a href="#">Sheet 01</a> |

**NOTE:** Depending on airline internal policy the Flight Kit No 2 may not be located in the place defined by [Fig. A-FBBAB Sheet 01](#). Refer to airline internal policy for exact location for Flight Kit No 2 and/or its contents.

(a) Remove in the Flight Kit No 2 (FIN 7503NW):

Refer to [Fig. A-FBBAB Sheet 01](#):

FIN 7955ME

|   |   |         |
|---|---|---------|
| 1 | AOA Sensor Protection 98D34203003000<br>Cover | Discard |
|---|---|---------|

FIN 7956ME

|   |   |         |
|---|---|---------|
| 1 | AOA Sensor Protection 98D34203003000<br>Cover | Discard |
|---|---|---------|

FIN 7957ME

|   |   |         |
|---|---|---------|
| 1 | AOA Sensor Protection 98D34203003000<br>Cover | Discard |
|---|---|---------|

(b) Install in the Flight Kit No 2 (FIN 7503NW):

Refer to [Fig. A-FBBAB Sheet 01](#)

FIN 7955ME

1 AOA Sensor Protection 98F10001000000  
Cover

FIN 7956ME

1 AOA Sensor Protection 98F10001000000  
Cover

FIN 7957ME

1 AOA Sensor Protection 98F10001000000  
Cover

### **\*\*CONF ALL**

#### **D. TEST**

### **\*\*CONF 001**

#### **(1) Subtask 345093-700-001-001 - Testing**

| Manpower Resources |              |
|--------------------|--------------|
| Skills             | NON SPECIFIC |

| References                        |  |
|-----------------------------------|--|
| Aircraft Maintenance Manual (AMM) | Task 20-28-00-720-805<br>Task 20-28-00-869-801 |

(a) Test of electrical bonding at level of the 7 screws item 1:

1 Do a check of the electrical bonding, refer to AMM Task 20-28-00-720-805.

**NOTE:** For the Maximum Permitted Resistance Values, refer to AMM Task 20-28-00-869-801.

(b) Make sure that the bonding contact resistance between the sensor and the fuselage structure is not higher than 5 milliohms as per AMM Task 20-28-00-720-805.

### **\*\*CONF 002**

#### **(1) Subtask 345093-700-001-001 - Testing**

| Manpower Resources |              |
|--------------------|--------------|
| Skills             | NON SPECIFIC |

| References                        |  |
|-----------------------------------|--|
| Aircraft Maintenance Manual (AMM) | Task 20-28-00-720-805<br>Task 20-28-00-869-801 |

(a) Test of electrical bonding at level of the 7 screws item 1:

1 Do a check of the electrical bonding, refer to AMM Task 20-28-00-720-805.

**NOTE:** For the Maximum Permitted Resistance Values, refer to AMM Task 20-28-00-869-801.

- (b) Make sure that the bonding contact resistance between the sensor and the fuselage structure is not higher than 5 milliohms as per AMM Task 20-28-00-720-805.

**\*\*CONF ALL**

**E. CLOSE-UP**

**\*\*CONF 001**

**(1) Subtask 345093-942-001-001 - Close-up**

| Manpower Resources |              |
|--------------------|--------------|
| Skills             | NON SPECIFIC |

| Material necessary to do the job |
|----------------------------------|
|                                  |

| Consumable CMLA01 |  |                           |             |           |
|-------------------|--|---------------------------|-------------|-----------|
| ITEM              | DESCRIPTION                              | REFERENCE TO CML MAT. No. | QTY PER A/C | SEE NOTES |
|                   | Release Agent                            | 05-013                    | As required |           |
|                   | Corrosion Inhibiting fillet Consistency  | 09-016                    | As required |           |
|                   | Fuel Tank Sealant Quick Repair Permanent | 09-058                    | As required |           |

| References                                 |   |
|--|---|
| Aircraft Maintenance Manual (AMM)          | 06-41-53, Page Block 001<br>Task 20-28-00-912-802<br>Task 20-28-00-912-804<br>Task 52-30-00-410-803<br>52-41-00, Page Block 001 |
| Elec. Std. Practices Manual (ESPM)         | 20-51-20  |
| Structural Repair Manual (SRM)             | 51-24-00  |
| Fig. A-FBAAA<br>Modification of the Plates | <a href="#">Sheet 01</a><br><a href="#">Sheet 02</a>  |

- (a) Protect the screws Item 1 in accordance with ESPM 20-51-20 and AMM Task 20-28-00-912-802 and/or AMM Task 20-28-00-912-804.
- (b) Blank off the hole located in front of the screw item (3) in accordance with SRM 51-24-00 and as shown on [Fig. A-FBAAA Sheet 02](#) with:

|   |        |             |
|---|--------|-------------|
| Release Agent                           | 05-013 | As required |
| Corrosion Inhibiting fillet Consistency | 09-016 | As required |

or

Fuel Tank Sealant    09-058                      As required  
 Quick Repair  
 Permanent

- (c) Make sure that the work areas are clean and clear of tools and other items of equipment.
- (d) Close the Bulk cargo-compartment door 823, refer to AMM Task 52-30-00-410-803.
- (e) Close the avionics compartment door 811, refer to AMM 06-41-53, Page Block 001 and AMM 52-41-00, Page Block 001.
- (f) Remove the access platform(s).
- (g) Restore the systems and the aircraft to normal operating condition.

**\*\*CONF 002**

**(1) Subtask 345093-942-001-002 - Close-up**

| Manpower Resources |              |
|--------------------|--------------|
| Skills             | NON SPECIFIC |

| Material necessary to do the job |
|----------------------------------|
|----------------------------------|

| Consumable CMLA01 |  |                           |             |           |
|-------------------|--|---------------------------|-------------|-----------|
| ITEM              | DESCRIPTION                              | REFERENCE TO CML MAT. No. | QTY PER A/C | SEE NOTES |
|                   | Release Agent                            | 05-013                    | As required |           |
|                   | Corrosion Inhibiting fillet Consistency  | 09-016                    | As required |           |
|                   | Fuel Tank Sealant Quick Repair Permanent | 09-058                    | As required |           |

| References                                 |   |
|--|---|
| Aircraft Maintenance Manual (AMM)          | 06-41-53, Page Block 001<br>Task 20-28-00-912-802<br>Task 20-28-00-912-804<br>Task 52-30-00-410-801<br>52-41-00, Page Block 001 |
| Elec. Std. Practices Manual (ESPM)         | 20-51-20  |
| Structural Repair Manual (SRM)             | 51-24-00  |
| Fig. A-FBAAA<br>Modification of the Plates | <a href="#">Sheet 01</a><br><a href="#">Sheet 02</a>  |

- (a) Protect the screws Item 1 in accordance with ESPM 20-51-20 and AMM Task 20-28-00-912-802 and/or AMM Task 20-28-00-912-804.

- (b) Blank off the hole located in front of the screw item (3) in accordance with SRM 51-24-00 and as shown on [Fig. A-FBAAA Sheet 02](#) with:

|               |        |             |
|---------------|--------|-------------|
| Release Agent | 05-013 | As required |
|---------------|--------|-------------|

|  |        |             |
|--|--------|-------------|
| Corrosion Inhibiting<br>fillet Consistency | 09-016 | As required |
|--|--------|-------------|

or

|  |        |             |
|--|--------|-------------|
| Fuel Tank Sealant<br>Quick Repair<br>Permanent | 09-058 | As required |
|--|--------|-------------|

- (c) Make sure that the work areas are clean and clear of tools and other items of equipment.
- (d) Close the FWD cargo-compartment door 821, refer to AMM Task 52-30-00-410-801.
- (e) Close the avionics compartment door 811, refer to AMM 06-41-53, Page Block 001 and AMM 52-41-00, Page Block 001.
- (f) Remove the access platform(s).
- (g) Restore the systems and the aircraft to normal operating condition.

**\*\*CONF ALL**

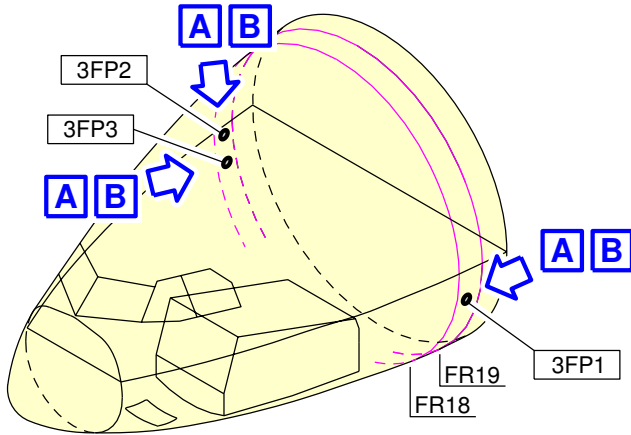

**BEFORE**

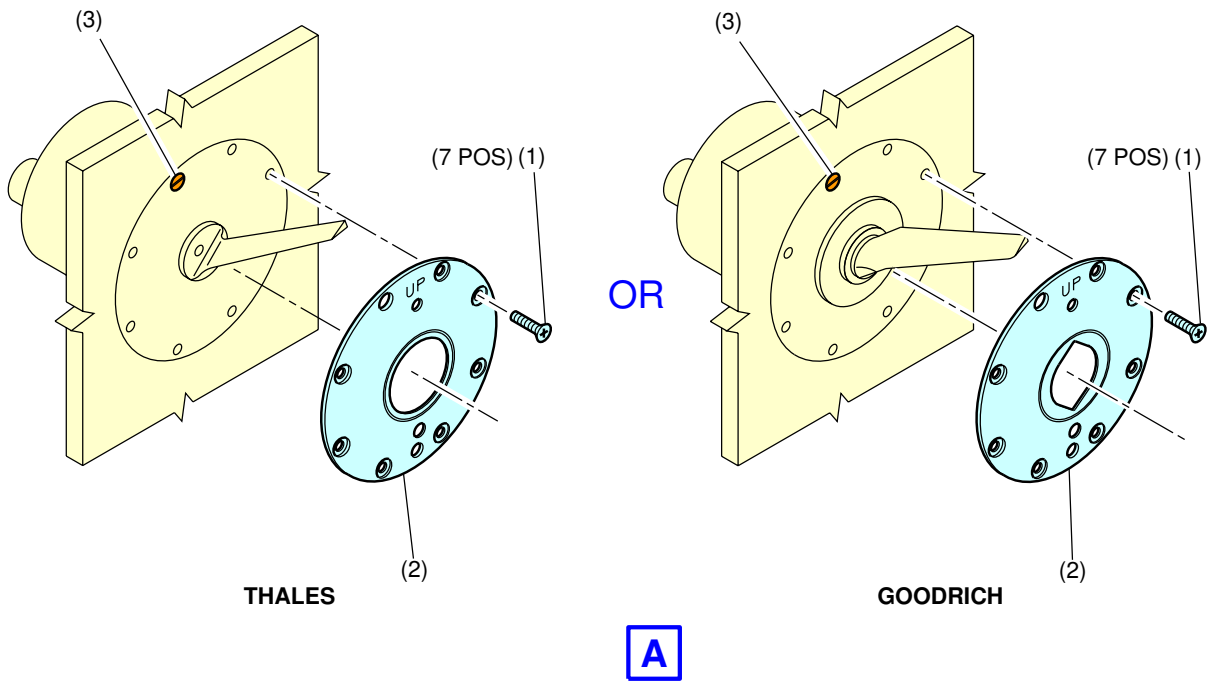

**NOTE:**

TYPICAL ILLUSTRATION ASSOCIATED WITH THALES OR GOODRICH AOA SENSORS.

F\_SB\_345093\_5\_BAAA\_01\_01

Figure A-FBAAA - Sheet 01  
Modification of the Plates

\*\*CONF ALL

**AFTER**

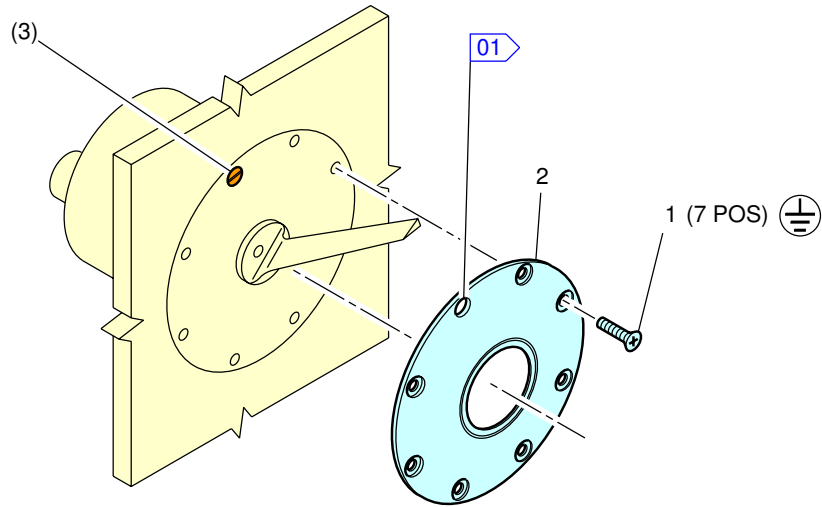

**B**

**NOTE:**

ONLY ONE CONFIGURATION SHOWN, AOA SENSOR  
DEPENDS ON AIRCRAFT CONFIGURATION.

**01** BLANK OFF THE HOLE LOCATED IN FRONT OF THE SCREW ITEM (3) WITH:  
MAT. No. 05-013 AND MAT. No. 09-058 OR 09-016.

 ELECTRICAL BONDING

F\_SB\_345093\_5\_BAAA\_02\_03

Figure A-FBAAA - Sheet 02  
Modification of the Plates

5 DATE: Jan 30/13

SERVICE BULLETIN No.: A340-34-5093

REVISION No.: 00 - Jan 30/13

Page: 32



**\*\*CONF 001**

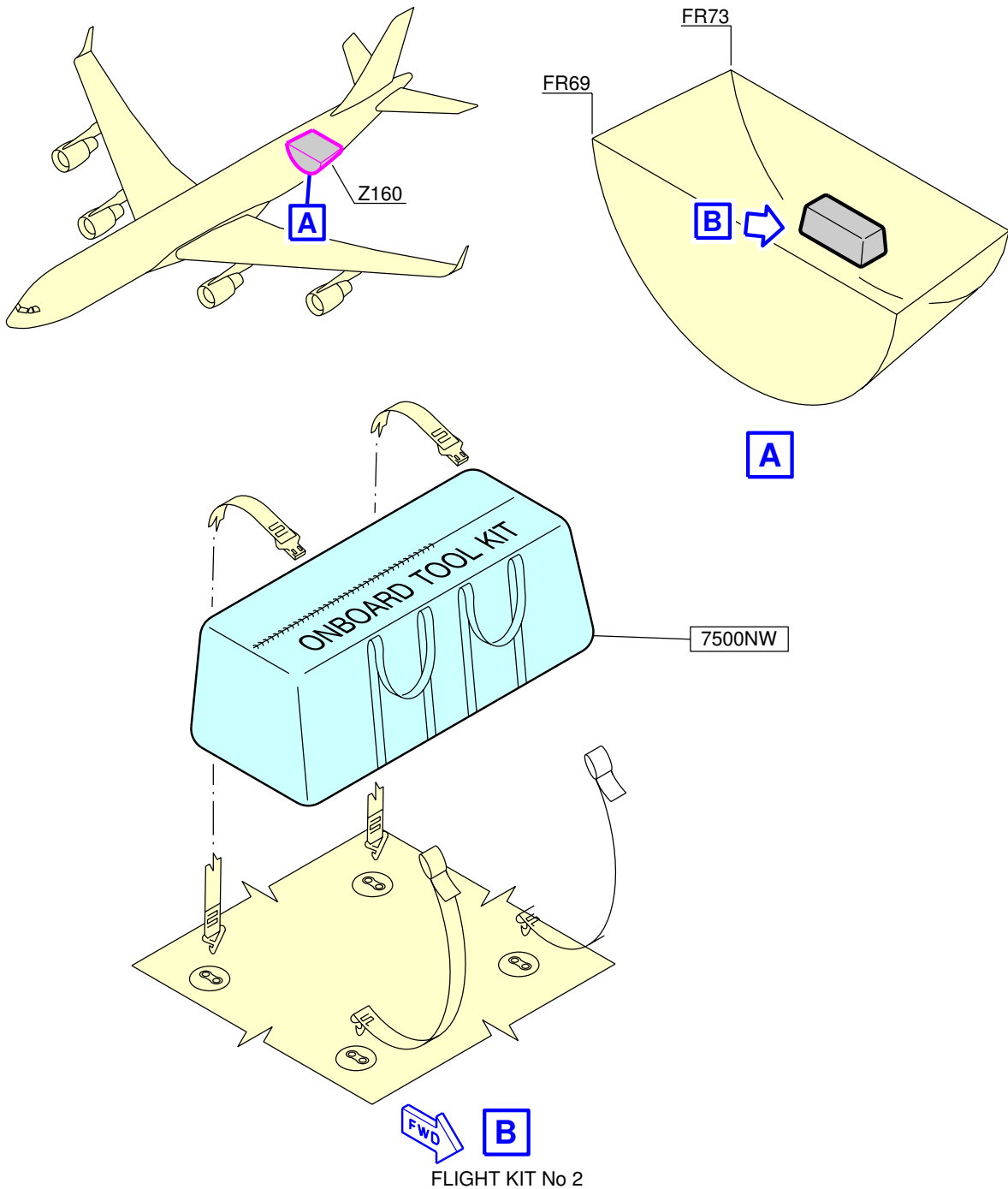

**NOTE:**

AOA PROTECTION COVERS FINs (7955ME, 7956ME AND 7957ME)  
ARE STORED IN FLIGHT KIT No 2 FIN (7500NW)

F\_SB\_345093\_5\_BBAA\_01\_02

Figure A-FBBAA - Sheet 01  
Modification of AOA Protection Covers in the Flight Kit No 2

# A340-500/600

## SERVICE BULLETIN

\*\*CONF 002

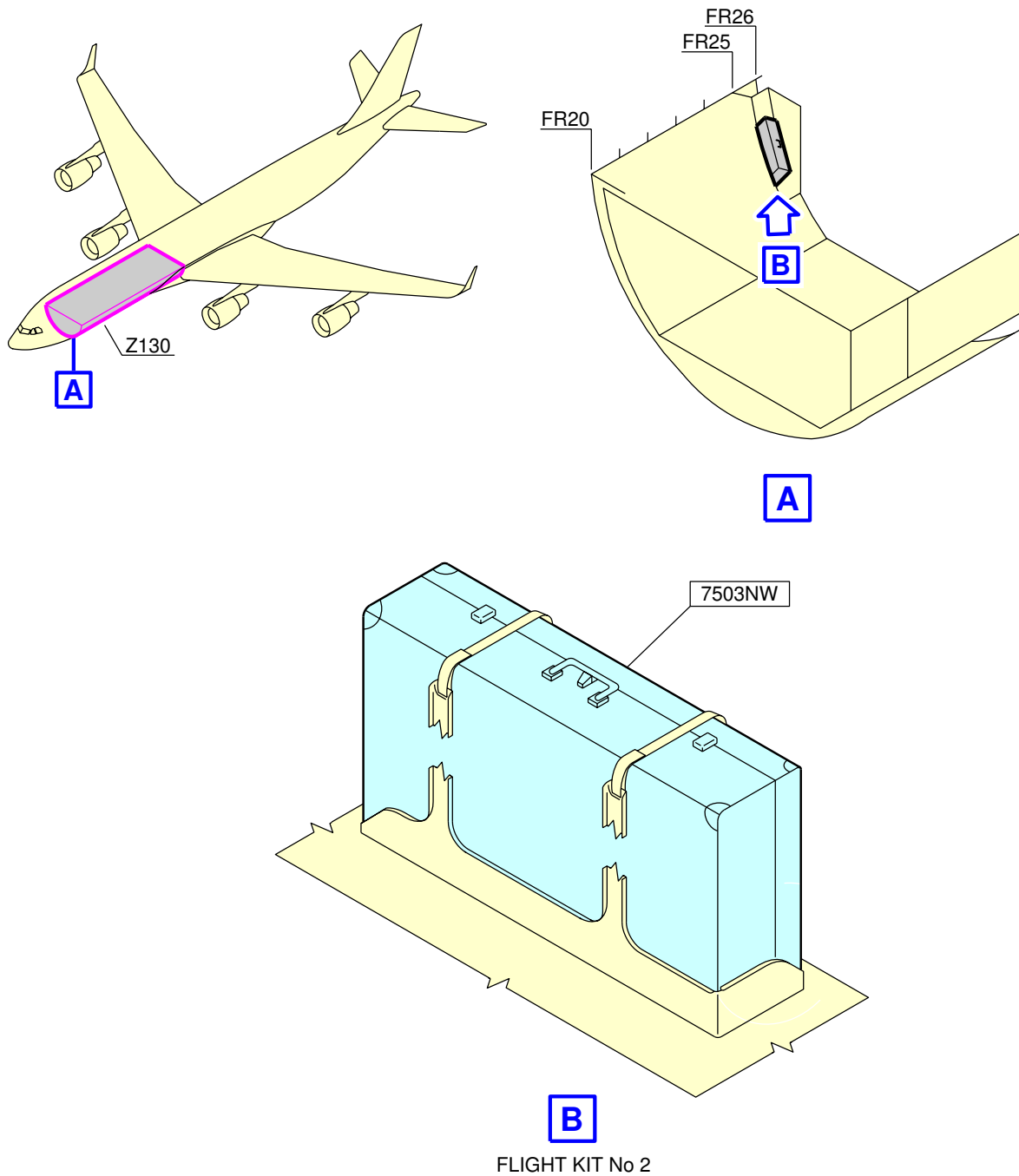

FLIGHT KIT No 2

**NOTE:**

AOA PROTECTION COVERS FINs (7955ME, 7956ME AND 7957ME) ARE STORED IN FLIGHT KIT No 2 FIN (7503NW)

F\_SB\_345093\_5\_BBAB\_01\_02

Figure A-FBBAB - Sheet 01  
Modification of AOA Protection Covers in the Flight Kit No 2

5 DATE: Jan 30/13

SERVICE BULLETIN No.: A340-34-5093

REVISION No.: 00 - Jan 30/13

Page: 34

# **A340-500/600**

## SERVICE BULLETIN APPENDIX 01: Elapsed Time Assumption

**\*\*CONF ALL**

- (1) The following Gantt chart is only a proposal operators may determine that another way to do the work is more suitable for them.

# A340-500/600

## SERVICE BULLETIN APPENDIX 01: Elapsed Time Assumption

**\*\*CONF ALL**

ELAPSED TIME ASSUMPTION SERVICE BULLETIN No A340-34-5093

01  
02

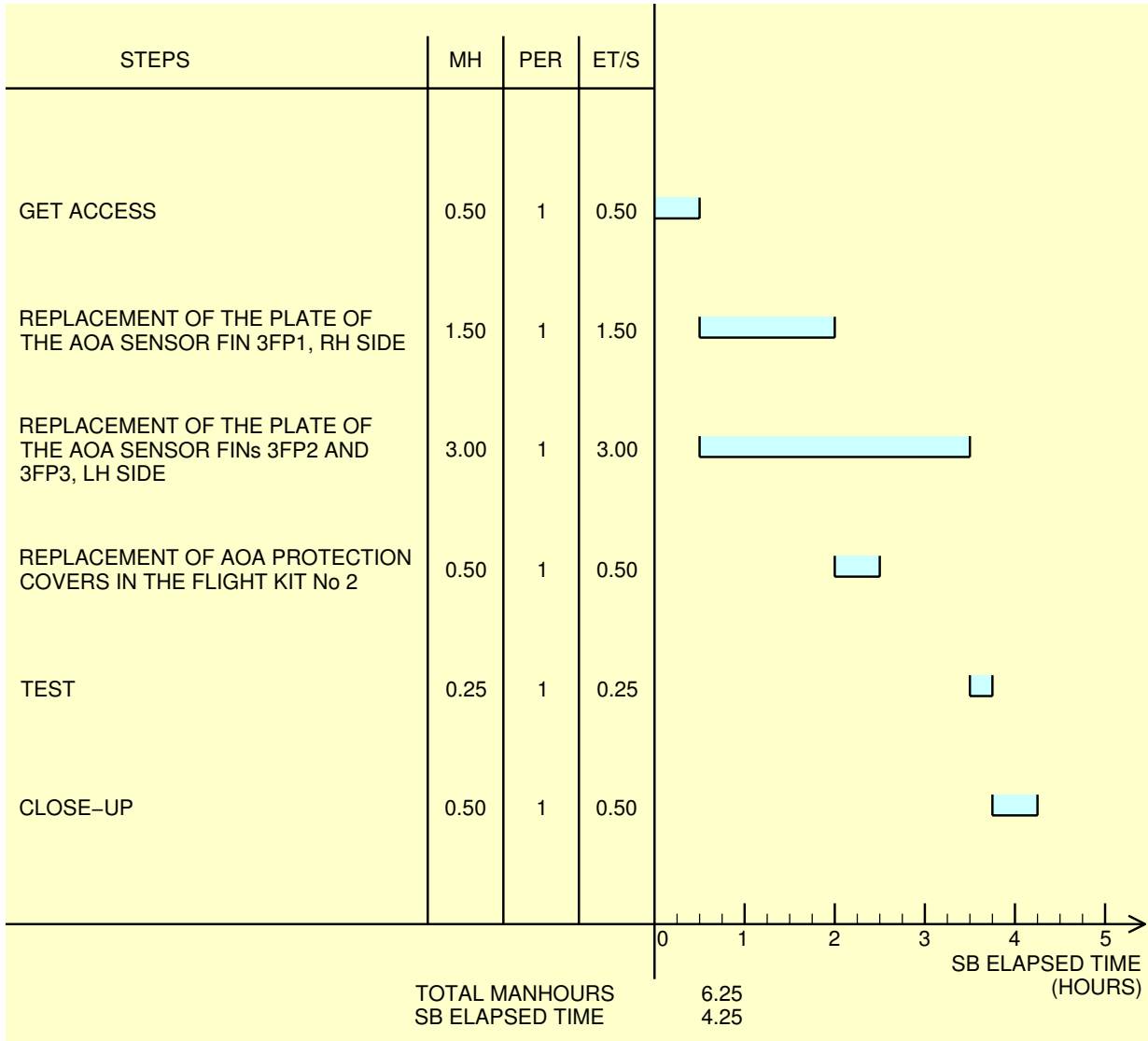

**NOTE:**

01 THIS CHART IS ONLY A PROPOSAL. OPERATORS MAY DETERMINE THAT ANOTHER WAY TO DO THE WORK IS MORE SUITABLE FOR THEM.

02 IF A VSB IS INVOLVED, THE ASSOCIATED MANHOURS ARE NOT REFLECTED IN THIS GANTT CHART.

MH : MANHOURS  
PER : NUMBER OF PERSONS  
ET/S: ELAPSED TIME PER STEP

F\_SB\_345093\_5\_AAAA\_01\_01

Figure A-FAAAA - Sheet 01  
Gantt Chart

5 DATE: Jan 30/13

SERVICE BULLETIN No.: A340-34-5093

REVISION No.: 00 - Jan 30/13

Page: 2

**TITLE: NAVIGATION - GENERAL - REPLACE AOA PROBE CONIC PLATE BY  
AOA PROBE FLAT PLATE**

MODIFICATION No.: 203295S32646

Please complete the appropriate item (A or B):A - SB WILL BE embodied YES/NO (if NO please comment)

If YES, aircraft concerned (as per SB effectivity by default) and planned dates (month/year) of embodiment:

B - SB HAS BEEN embodied on aircraft:

Operator comments:

From Airline:

Name/Title:

Signature:

Date:

If operational documentation is affected (see Paragraph 1.K of this SB): If information is needed prior to next normal revision or prior to SB embodiment, please indicate required service(s):

Either: Modification Operational Impact (MOI), if available

YES/NO

Or : Intermediate revision

YES/NO

Important Information: This SB will only be incorporated in your maintenance and operational documentation if this sheet is returned to Airbus and signed by a duly authorised representative. With the next feasible revision, this will result in

- Updating of maintenance documentation to show pre and post SB data.
- Updating of maintenance and operational documentation to show post SB data after embodiment.

If this SB requires previous or simultaneous accomplishment of other SBs, Airbus shall automatically include them in the manual revisions. Refer to SIL 00-037 for detailed information.

Please return this completed sheet to:AIRBUS  
CUSTOMER SERVICES DIRECTORATE  
1 Rond Point Maurice Bellonte  
31707 BLAGNAC CEDEX FRANCE

Attn: SDC32 Technical Data and Documentation Services

FAX: (+33) 5 61 93 28 06

e-mail: sb.reporting@airbus.com

or via your Resident Customer Support Office.

Alternatively, SB lists via letters or fax are also accepted.

## SERVICE BULLETIN QUALITY PERCEPTION FORM

Use this form to tell us what is your perception of the quality of this Service Bulletin. The reported data that you provide us will be used to analyse areas of difficulties and to take corrective action to further improve the quality of our Service Bulletins.

We thank you for the time you have taken in completing this form.

(Please rate on a scale of 1 to 4, with 4 being the highest score)

|   |       |   |   |   |
|---|-------|---|---|---|
| - Quality rating of this SB                         | 4     | 3 | 2 | 1 |
| - Quality rating of the Accomplishment Instructions | 4     | 3 | 2 | 1 |
| - Quality rating of the Illustrations               | 4     | 3 | 2 | 1 |
| - Is this SB easy to understand ?                   | Y / N |   |   |   |

If you have had difficulties in the accomplishment of this SB please quote below the area(s) and give a short description of the issue.

| Planning  | Material  | Instructions                                       |
|---|---|--|
| <input checked="" type="checkbox"/> Effectivity | <input checked="" type="checkbox"/> Kit content                         | <input checked="" type="checkbox"/> Preparation    |
| <input checked="" type="checkbox"/> Reason      | <input checked="" type="checkbox"/> List of Materials Operator Supplied | <input checked="" type="checkbox"/> Mod/Inspection |
| <input checked="" type="checkbox"/> Manpower    | <input checked="" type="checkbox"/> Industry support                    | <input checked="" type="checkbox"/> Test           |
| <input checked="" type="checkbox"/> References  | <input checked="" type="checkbox"/> Re-identification                   | <input checked="" type="checkbox"/> Close-Up       |
| <input checked="" type="checkbox"/> Publication | <input checked="" type="checkbox"/> Tooling                             | <input checked="" type="checkbox"/> Illustrations  |

Comments:

Operator:

Date:

Name/Title:

Please return this form to:

AIRBUS  
CUSTOMER SERVICES DIRECTORATE  
1 Rond Point Maurice Bellonte  
31707 BLAGNAC CEDEX FRANCE

Attn : SEM4 Service Bulletins Management  
FAX : (33) 5 61 93 42 51

Or via your Resident Customer Support Office.