

EASA	EMERGENCY AIRWORTHINESS DIRECTIVE
	AD No.: 2010-0063-E Date: 01 April 2010 Note: This Emergency Airworthiness Directive (AD) is issued by EASA, acting in accordance with Regulation (EC) No 216/2008 on behalf of the European Community, its Member States and of the European third countries that participate in the activities of EASA under Article 66 of that Regulation
This AD is issued in accordance with EC 1702/2003, Part 21A.3B. In accordance with EC 2042/2003 Annex I, Part M.A.301, the continuing airworthiness of an aircraft shall be ensured by accomplishing any applicable ADs. Consequently, no person may operate an aircraft to which an AD applies, except in accordance with the requirements of that AD, unless otherwise specified by the Agency [EC 2042/2003 Annex I, Part M.A.303] or agreed with the Authority of the State of Registry [EC 216/2008, Article 14(4) exemption].	
Type Approval Holder's Name : ATR - GIE Avions de Transport Régional	Type/Model designation(s) : ATR72-212A aeroplanes
TCDS Number : EASA.A.084	
Foreign AD : Not applicable	
Supersedure : None	
ATA 27	Flight Controls – Rudder Pedal Rods – Inspection / Replacement
Manufacturer(s):	ATR - GIE Avions de Transport Régional (formerly AEROSPATIALE – AERITALIA, AEROSPATIALE – ALENIA, AEROSPATIALE ATR– ALENIA, EADS ATR – ALENIA)
Applicability:	ATR 72-212A aeroplanes, manufacturer serial numbers (MSN) 886, 897, 901, 902, 903, 904 and 906.
Reason:	<p>During flight control checks prior to take-off (cockpit pre-flight preparations), abnormal motion of the rudder pedal was observed in two ATR72-212A aeroplanes, the affected pedal staying stuck on its stop end position. Subsequent inspection showed that in both cases, one of the rudder pedal rods, Part Number (P/N) S2728116400000, was broken.</p> <p>Further investigation revealed that an error has occurred during the manufacturing process of the affected rods. As a result, some of the rods (which have been identified as belonging to production batch numbers CC 2109699 and CC 2118930) may have an outer diameter which is smaller than the minimum value as specified in the original design drawings.</p> <p>The rods belonging to these batches were installed in the rudder pedal assemblies of certain aeroplanes. Most of the related rods have been checked and found to be in conformity with acceptable dimensions; those that were not have been replaced while still on the production line, prior to delivery of the affected aeroplanes. However, seven (7) aeroplanes already in service have been identified that are likely to have the affected rods installed.</p> <p>This condition, if not corrected, could lead to failure of the rudder pedal rod, possibly resulting in reduced control of the aeroplane. In combination with an engine failure or during a landing or take-off under crosswind conditions, such a</p>

	<p>failure could lead to loss of control of the aeroplane.</p> <p>For the reasons described above, this Emergency AD requires inspection of the four rudder pedal rods, to detect a lower than acceptable outer diameter at each rod end, and replacement of any rods that fail the inspection criteria.</p>
Effective Date:	06 April 2010
Required Action(s) and Compliance Time(s):	<p>Required as indicated, unless previously accomplished.</p> <ol style="list-style-type: none"> (1) Within two days after the effective date of this AD, inspect the four rudder pedal rods in accordance with the following procedure: <ol style="list-style-type: none"> (1.1) Remove both LH (captain) and RH (first officer) cockpit seats in accordance with ATR Job Instruction Card (JIC) 25-11-11 RAI 10000. (1.2) Remove the LH and RH rudder pedal cover assemblies (ATR IPC figure 27-21-10-01 item 30B). (1.3) For each one of the four (4) rudder pedal rods P/N S2728116400000 (ATR IPC fig. 27-21-10-01 item 070) identify the production batch number and the serial number printed on the rod's surface. (1.4) For any rod identified as belonging to batch CC 2109699 or batch CC 2118930, and for any rod for which the batch number cannot be identified, inspect the rod diameter on the cylindrical area of each rod end (rod end on pedal side and rod end on lever side) as shown on the figure in Appendix 1 of this AD, using the inspection tool P/N 98S27205004-200 as provided by ATR. (2) Before next flight, replace any rudder pedal rod P/N S2728116400000 that has failed the inspection as required by paragraph (1.4) of this AD, contact ATR for approved instructions to replace each removed rudder pedal rod with a serviceable part and accomplish those instructions accordingly. (3) If all four rods pass the inspection as required by paragraph (1.4) of this AD, re-install LH and RH rudder pedal cover assemblies (ATR IPC figure 27-21-10-01 item 30B) and associated seats in accordance with ATR Job Instruction Card (JIC) 25-11-11 RAI 10000. (4) Within 10 days after the inspection as required by paragraph (1.4) of this AD, report the results (including no findings) to ATR by using the Inspection Reporting Form provided in Appendix 2 of this AD and, within 30 days after removal (if any), return the removed rods to ATR.
Ref. Publications:	<p>ATR42/72 Job Instruction Card AMM JIC 25-11-11 RAI 10000.</p> <p>ATR42/72 IPC 27-21-10.</p>
Remarks :	<ol style="list-style-type: none"> 1. If requested and appropriately substantiated, EASA can approve Alternative Methods of Compliance for this AD. 2. The safety assessment has requested not to implement the full consultation process and an immediate publication and notification. 3. Enquiries regarding this AD should be referred to the Airworthiness Directives, Safety Management & Research Section, Certification Directorate, EASA. E-mail: ADs@easa.europa.eu. 4. For any question concerning the technical content of the requirements in this AD, please contact: ATR - GIE Avions de Transport Régional Continued Airworthiness Service Tel.: +33 (0)5 62 21 62 21 - Fax: +33 (0) 5 62 21 67 18 E-mail: continued.airworthiness@atr.fr.

Appendix 1

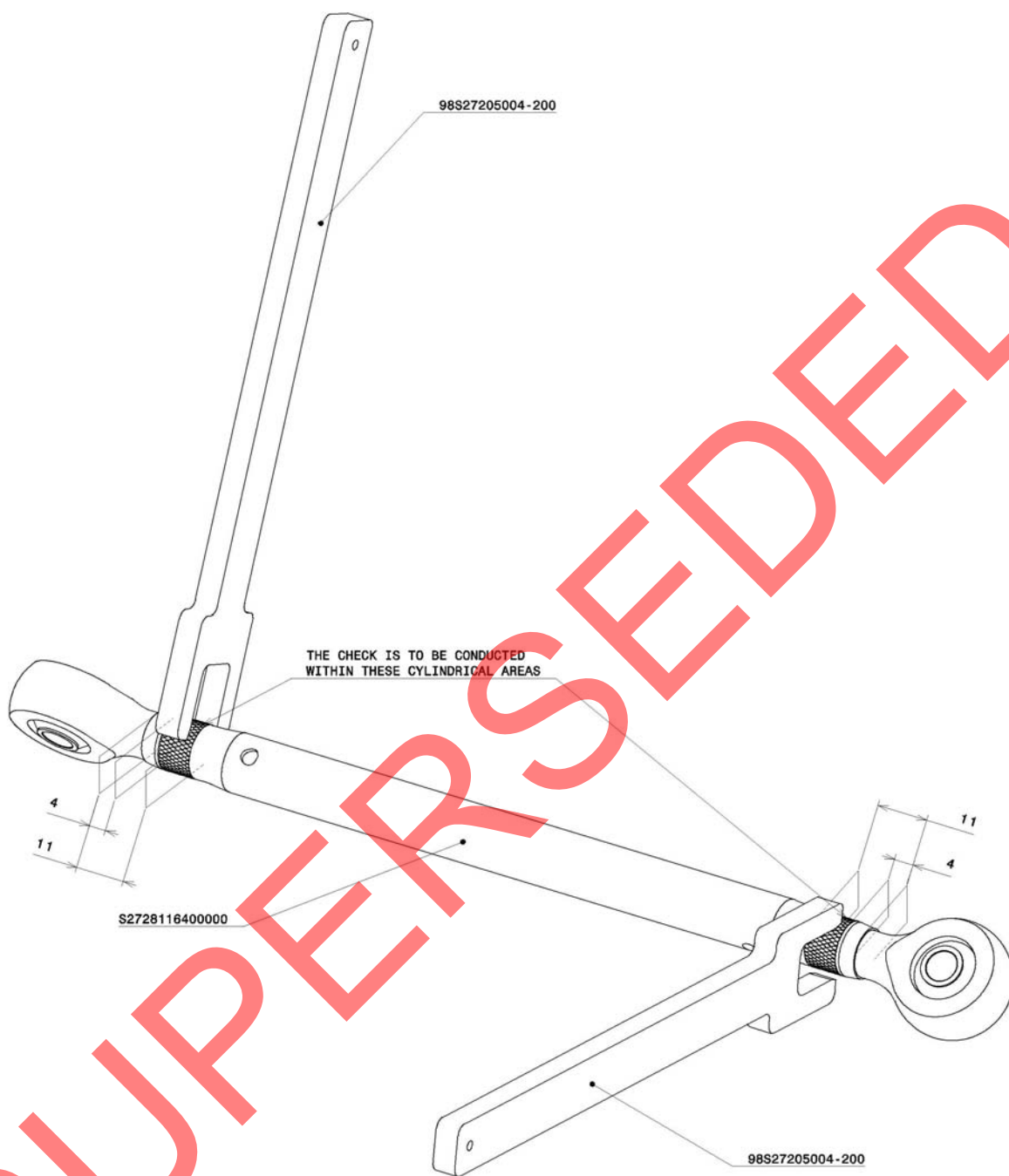

Note: The design drawing of the rod specifies a diameter of 11 +/- 0.25 mm at this section.

Accepted

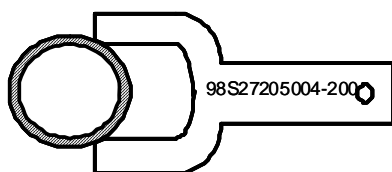

Not Accepted

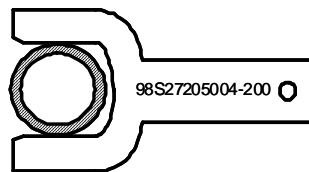

- If the tool fits over the rod outer diameter, the rod must be replaced with a serviceable part.
- If the tool does not fit over the rod outer diameter, the rod can remain installed.

Appendix 2

Inspection Reporting Form

A/C MSN:	A/C Registration:		Inspection date:	
	LH (Captain) Pedal Assembly		RH (F/O) Pedal Assembly	
	LH Rod	RH Rod	LH Rod	RH Rod
	Position 1	Position 2	Position 3	Position 4
Batch number				
S/N in batch				
<p><u>If batch number is CC 2109699 or CC 2118930 or rod identification not readable, fill the fields here below</u></p> <p><u>Inspection must be performed with the tool P/N 98S27205004-200</u></p>				
Rod end on pedal side	Accepted <input type="checkbox"/> Not Accepted <input type="checkbox"/>	Accepted <input type="checkbox"/> Not Accepted <input type="checkbox"/>	Accepted <input type="checkbox"/> Not Accepted <input type="checkbox"/>	Accepted <input type="checkbox"/> Not Accepted <input type="checkbox"/>
Rod end on lever side	Accepted <input type="checkbox"/> Not Accepted <input type="checkbox"/>	Accepted <input type="checkbox"/> Not Accepted <input type="checkbox"/>	Accepted <input type="checkbox"/> Not Accepted <input type="checkbox"/>	Accepted <input type="checkbox"/> Not Accepted <input type="checkbox"/>

Once completed, send this form to techdesk@atr.fr and continued.airworthiness@atr.fr